

SPECIFICATIONS:

MODEL NUMBER: 8005-991-837

PUMP DESIGN: Positive Displacement 3 Chamber Diaphragm Pump

CHECK VALVE: (1-Way Operation) Prevents Reverse Flow

CAM: 2.0 Degree

MOTOR: Permanent Magnet, P/N 11-124-10, Thermally Protected

VOLTAGE: 24 VDC Nominal

PRESSURE SWITCH: Adjustable Shut-Off (Range 60-80 PSI)

Factory Set @ 80 PSI, Turn On 60 PSI ± 5 PSI

LIQUID TEMPERATURE: 180 Degrees Fahrenheit (82 Degrees Centigrade) Max.

PRIME: Self-Priming Up To 7 Ft. Vertical,
Max. Inlet Pressure 30 PSI (2.1 Bar)

PORTS: 3/8" - 18 NPT Female

MATERIAL OF CONSTRUCTION:

PLASTICS- Nylon

VALVES- EPDM

DIAPHRAGM- Santoprene

FASTENERS- Stainless Steel

NET WEIGHT: 3.5 Lbs (1.6 Kg)

DUTY CYCLE: Intermittent (See Temperature Rise Chart)

APPROVALS: NSF Listed

TYPICAL APPLICATIONS: R.O. Booster Pump

DIMENSIONS:

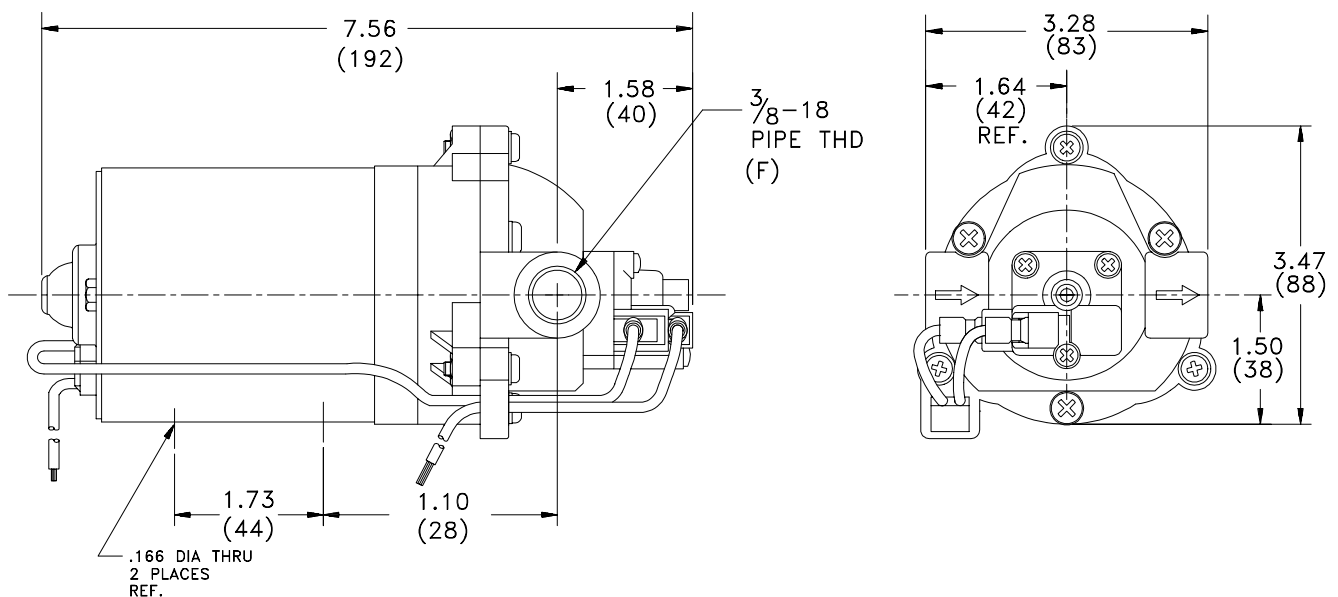

TEMPERATURE RISE

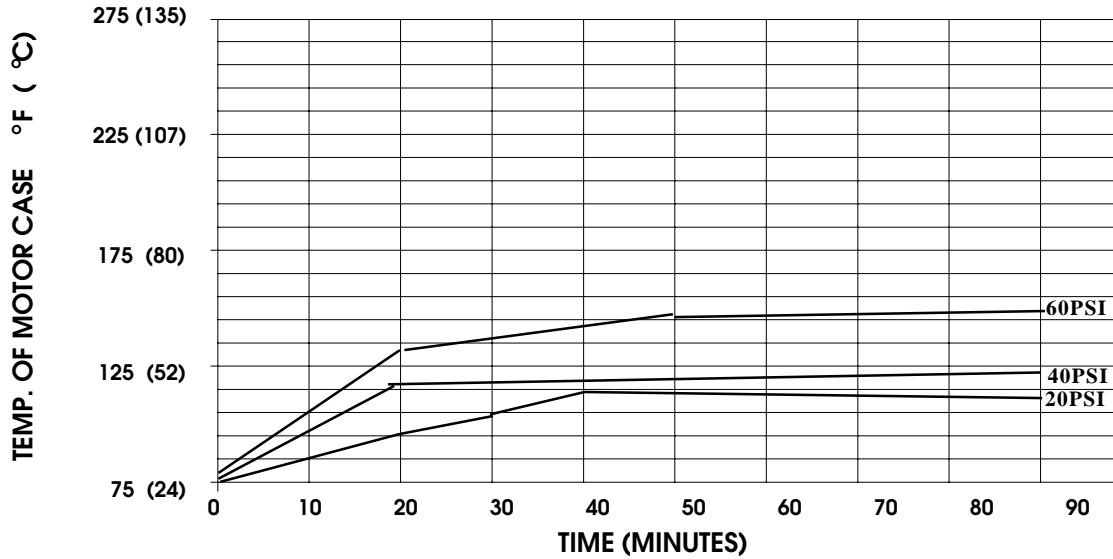

THIS GRAPH IS FOR USE AS A DESIGN GUIDE. IT IS BASED ON RUNNING CONTINUOUSLY WITH AN AMBIENT TEMPERATURE OF 75°F IN STILL AIR. THE THERMAL BREAKER WILL OPEN WHEN THE CASE TEMPERATURE REACHES 230°F.

[- - - - - TRIP POINT OF THERMAL PROTECTOR]

TYPICAL PERFORMANCE

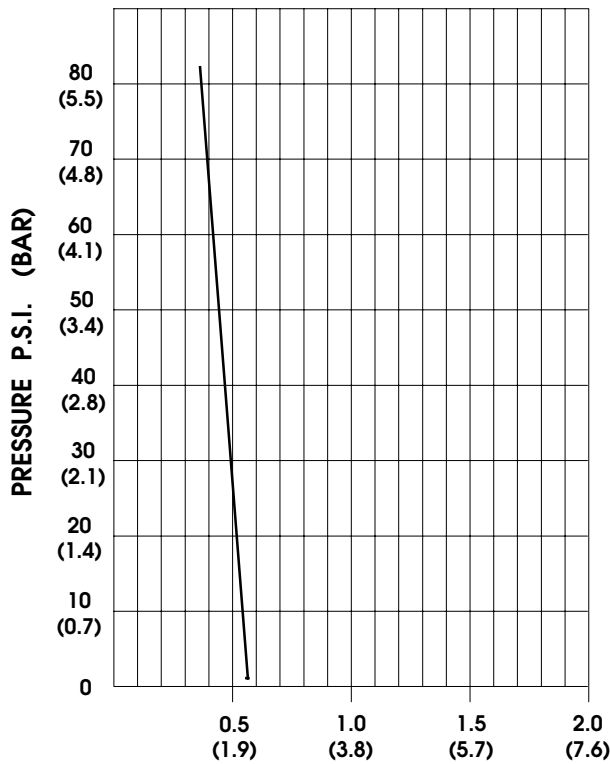

PRESSURE (PSI)	FLOW (GPM/LIT)	RPM MIN/MAX	CURRENT (AMPS)	VOLTAGE (VOLTS)
OPEN	0.55/2.1	1380/1440	0.54	24VDC
10	0.52/2.0	1350/13.80	0.65	
20	0.50/1.9	1290/1310	0.79	
30	0.46/1.7	1220/1230	0.94	
40	0.43/1.6	1145/1155	1.09	
50	0.41/1.5	1080/1090	1.23	
60	0.39/1.4	1005/1015	1.36	
70	0.36/1.3	945/960	1.50	
80	0.33/1.2	865/875	1.64	

FLOW - GALLONS PER MINUTE (LITERS PER MINUTE)

-SPECIFICATIONS SUBJECT TO CHANGE WITHOUT NOTICE.

-ALL DATA BASED ON TESTING WITH WATER AT AMBIENT TEMPERATURE.