

SPECIFICATIONS:

MODEL NUMBER: 8004-251-227

PUMP DESIGN: Positive Displacement 3 Chamber Diaphragm Pump

CHECK VALVE: (1-Way Operation) Prevents Reverse Flow

CAM: 2.0 Degree

MOTOR: Permanent Magnet, P/N 11-190-00, Thermally Protected

VOLTAGE: 24 VAC Nominal

PRESSURE SWITCH: Adjustable Shut-Off (Range 40-75 PSI)

Factory Set @ 75 PSI, Turn On 60 PSI ± 5 PSI

LIQUID TEMPERATURE: 170 Degrees Fahrenheit (77 Degrees Centigrade) Max.

PRIME: Self-Priming Up To 9 Ft. Vertical,
Max. Inlet Pressure 30 PSI (2.1 Bar)

PORTS: 3/8"-18 NPT Female

MATERIAL OF CONSTRUCTION:

PLASTICS- Polypropylene

VALVES- EPDM

DIAPHRAGM- Santoprene

FASTENERS- Zinc Plated Steel

NET WEIGHT: 3.6 Lbs (1.6 Kg)

DUTY CYCLE: Intermittent (See Temperature Rise Chart)

TYPICAL APPLICATIONS: Arc Welding Cooling Unit

BYPASS: 45 + 60 PSI Springs

DIMENSIONS:

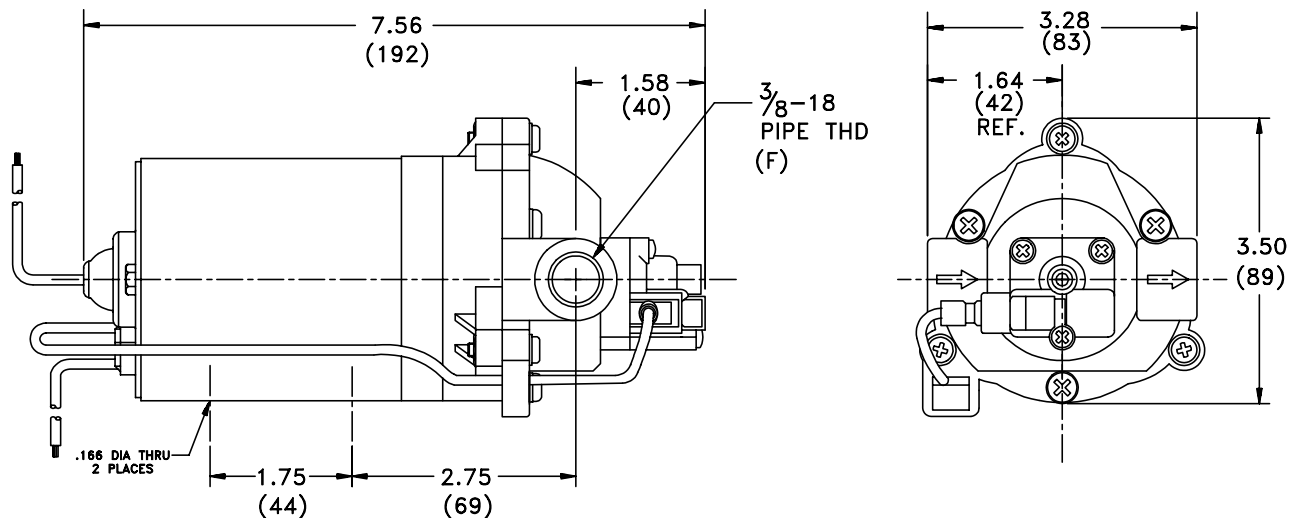

TEMPERATURE RISE

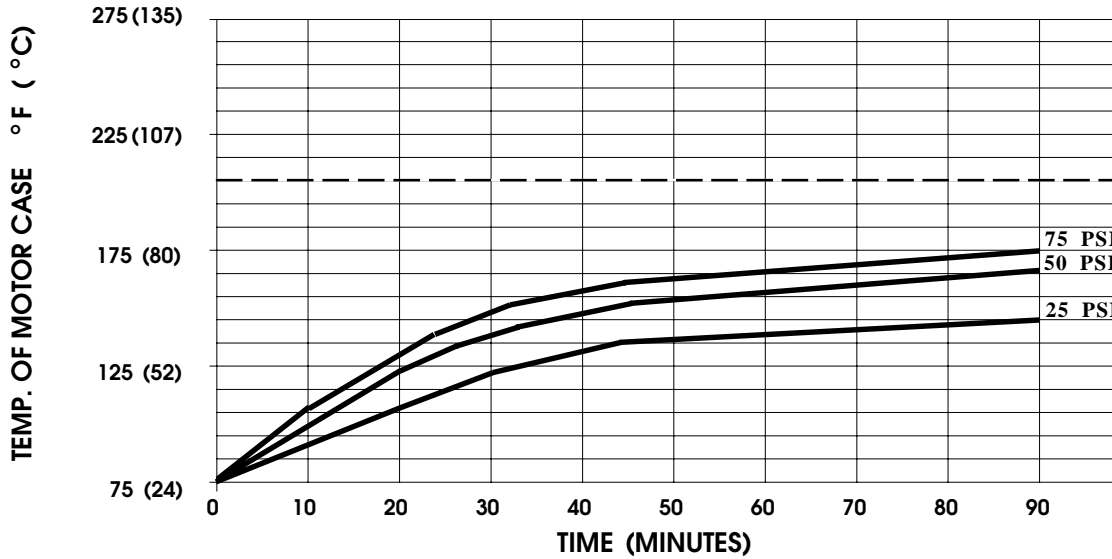

THIS GRAPH IS FOR USE AS A DESIGN GUIDE. IT IS BASED ON RUNNING CONTINUOUSLY WITH AN AMBIENT TEMPERATURE OF 70°F IN STILL AIR. THE THERMAL BREAKER WILL OPEN WHEN THE CASE TEMPERATURE REACHES 205°F.

[- - - - - TRIP POINT OF THERMAL PROTECTOR]

TYPICAL PERFORMANCE

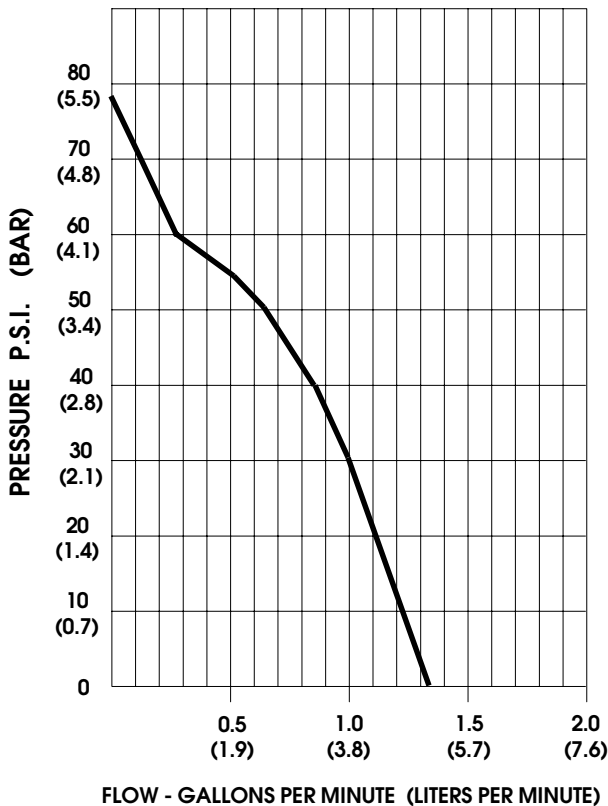

| PRESSURE (PSI) | FLOW (GPM/LIT) | RPM MIN/MAX | CURRENT (AMPS) | VOLTAGE (VOLTS) |
|----------------|----------------|-------------|----------------|-----------------|
| OPEN | 1.33/5.0 | 2515/2725 | 1.6 | 24 VAC |
| 10 | 1.27/4.8 | 2430/2630 | 1.7 | " |
| 20 | 1.18/4.5 | 2330/2415 | 1.9 | " |
| 30 | 1.02/3.9 | 2215/2282 | 2.2 | " |
| 40 | 0.86/3.5 | 2130/2160 | 2.5 | " |
| 50 | 0.64/2.4 | 2005/2065 | 2.7 | " |
| 60 | 0.26/1.0 | 1960/1995 | 2.9 | " |
| 70 | 0.06/0.2 | 1905/1985 | 3.0 | " |

-SPECIFICATIONS SUBJECT TO CHANGE WITHOUT NOTICE.

-ALL DATA BASED ON TESTING WITH WATER AT AMBIENT TEMPERATURE.