

LECTRA/SAN[®] MC

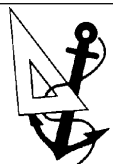
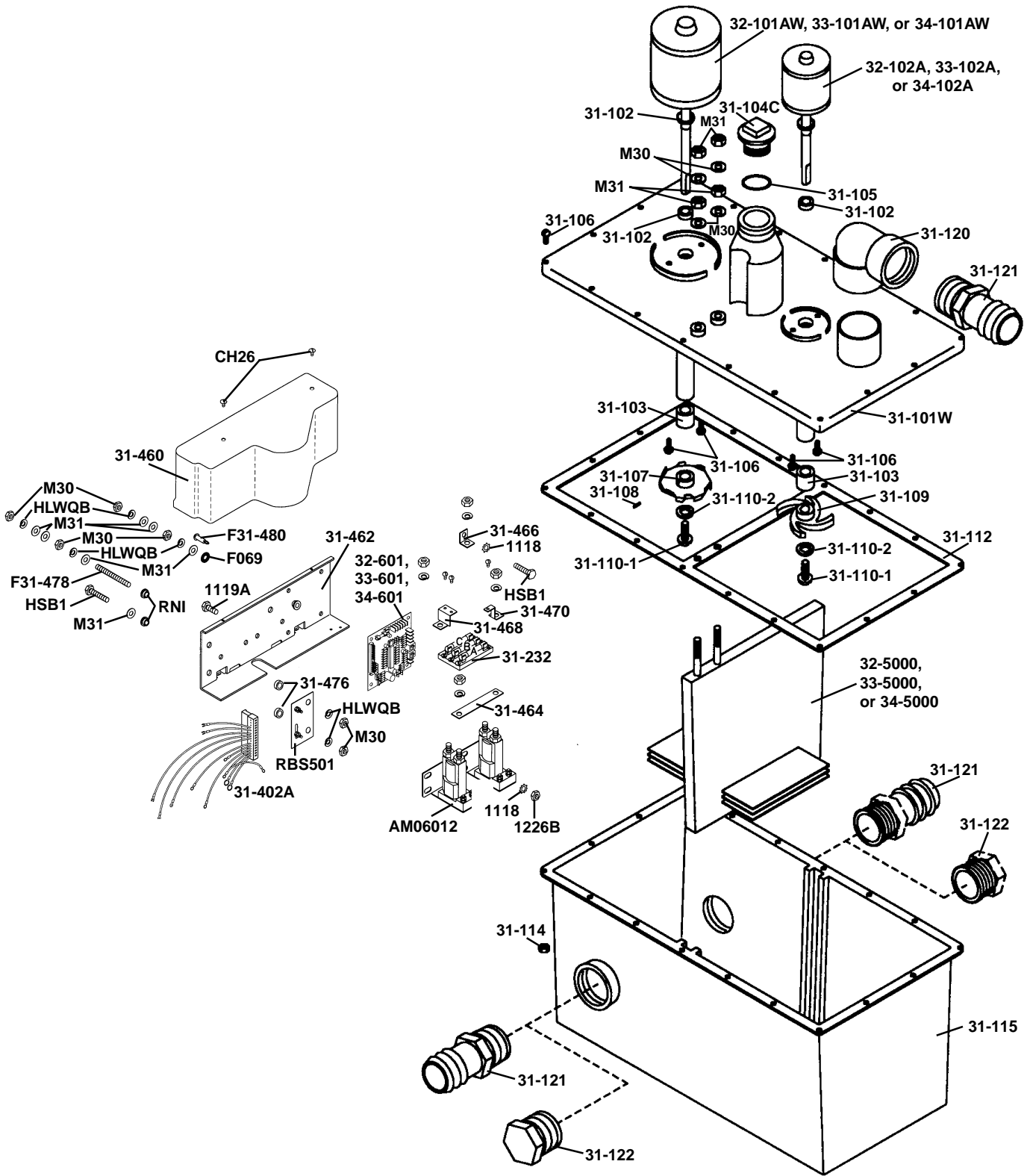

RARITAN
Engineering Company, Inc.

530 Orange Street, P.O. Box 1157, Millville, NJ 08332 USA
 Telephone: 856-825-4900 FAX: 856-825-4409
 www.raritaneng.com
 Southern Office and Plant:
 3101 SW Second Ave., Fort Lauderdale, FL 33315 USA
 Telephone: 954-525-0378 FAX: 954-764-4370

PARTS LIST **Lectra/San**® MC

<u>Part No.</u>	<u>Description</u>	<u>Part No.</u>	<u>Description</u>
1118	¼" External Tooth Washer (5)	31-606	Pressure Switch for Activator (not shown)
1119A	¼ - 20 x 1/2" S/S Hex Head Machine Screw (4)	32-101AW**	Macerator Motor 3" Dia. 12 VDC
1226B	¼ - 20 S/S Hex Head Nut (4)	33-101AW**	Macerator Motor 3" Dia. 24 VDC
31-101W	Treatment Cover (Includes 31-103, 31-104B, and 31-102)	34-101AW**	Macerator Motor 3" Dia. 32 VDC
31-102	Motor Shaft Seal (2)	32-102**	Mixer Motor 2 1/2" Dia. 12 VDC
31-103	Motor Shaft Bushing (2)	33-102**	Mixer Motor 2 1/2" Dia. 24 VDC
31-104C	Crossover Plug	34-102**	Mixer Motor 2 1/2" Dia. 32 VDC
31-105	O-Ring	32-4000*	Complete Treatment Unit 12 VDC
31-106	10-32x7/8" RHMS, S/S (22)[Motor hold down bolts must be completely covered with silicone caulk before final reassembly to prevent leaking]	33-4000*	Complete Treatment Unit 24 VDC
31-107	Macerator Impeller	34-4000*	Complete Treatment Unit 32 VDC
31-108	Macerator Set Screw, 8-32x3/16", S/S	32-601	Circuit Board Assy., 12V
31-109	Mixer Impeller	33-601	Circuit Board Assy., 24V
31-110-1	Impeller Bolt, 12-24x5/8", S/S (2)	34-601	Circuit Board Assy., 32V
31-110-2	Impeller Lock Washer, #12, S/S (2)	32-602	Control Module Assy., 12V
31-112	Cover Gasket	33-602	Control Module Assy., 24V
31-114	Cover Hold Down Nut, 10-32 (18)	34-602	Control Module Assy., 32V
31-115	Treatment Tank	32-5000	Electrode Pack 12 VDC
31-120	Discharge Elbow 90	33-5000	Electrode Pack 24 VDC
31-121	Hose Fitting (2)	34-5000	Electrode Pack 32 VDC
31-122	Intake Plug	AM06012	Solenoid Relay (2) -12V
31-232	Fuse Block	AM06024	Solenoid Relay (2) - 24V
31-3001	Two gallon Salt feed tank (not included, not shown)	AM06032	Solenoid Relay (2) - 32V
31-3002	Four gallon salt feed tank (not included, not shown)	CH26	8-32 x 7/16" Truss Head Screw(2)
32-3003	Four galon salt feed tank w/12 volt pump (not included, not shown)	F069	Gray Fiber Flat Washer
33-3003	Four gallon salt feed tank w/24 volt pump (not included, not shown)	F145VT	10-32 x 1¾" pan head screw, S/S (not shown)
31-402 A	Wiring Harness Assy.	F31-478	Threaded Rod ¼ - 20 x 2" Brass
31-460	Control Cover	F31-480	Nylon Stand Offs: PCB Supports (4)
31-462	Mounting Plate	HLWQB	¼" Lockwasher (6)
31-464	Bracket	HSB1	¼ - 20 Brass Cap Screw (2)
31-466	Bracket	M30	Electrode Flat Washer, ¼", Brass (4)
31-468	Bracket	M31	Electrode Lug Nut, ¼"-20 Brass (4)
31-470	Cond. Bracket	RBS501	Shunt 50mv, 50 amp for LST/MC
31-476	Nylon Spacer Washer (2)	RNI	Nylon Shoulder Washer (3)
31-603	Control Indicator Panel (not shown)		
31-604	Control Indicator Panel Cable (not shown)		
31-605	Activator Assembly for Manual Toilets (not shown)		

* Less Control Module

() Indicates Total Pieces Required

**NOTE: When replacing existing or new motor(s), apply silicone caulk over motor hold down bolt heads (see 31-106). Dispense enough sealant to cover an area three times greater than the bolt heads to avoid leakage through bolt holes.

Lectra/San MC Fuse Chart (All fuses are MDL)			
Fuse	12VDC	24VDC	32VDC
"A"	32-218(61/4 amp)	32-218(61/4 amp)	34-218(5 amp)
"B"	32-219(35 amp)	32-220(30 amp)	32-220(30 amp)
"C"	32-220(30 amp)	33-220(25 amp)	34-220(20 amp)