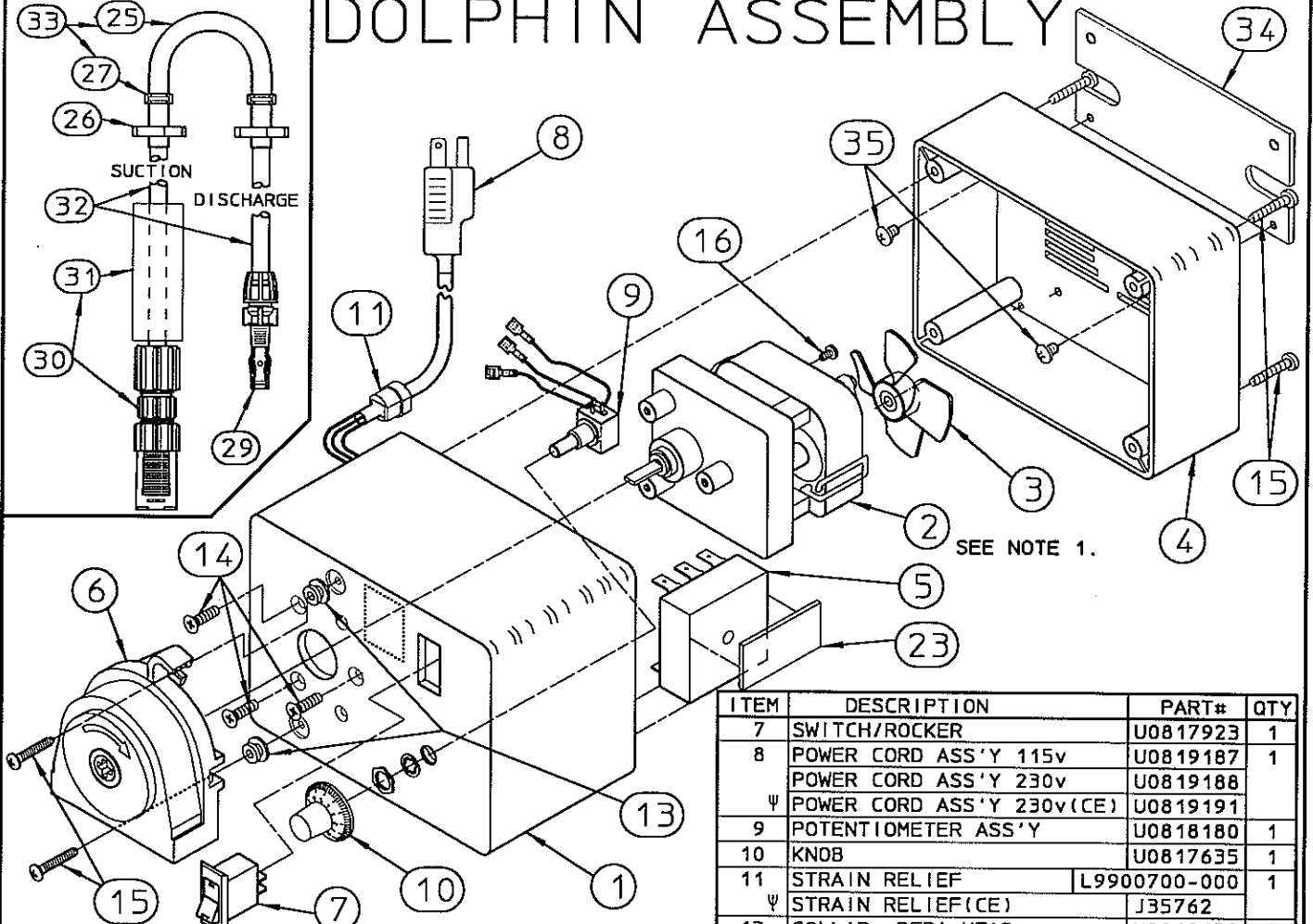

FIGURE #8

DOLPHIN ASSEMBLY



SEE NOTE 1.

ITEM	DESCRIPTION	PART#	QTY
1	PUMP HOUSING	U0819142	1
ψ	PUMP HOUSING(CE)	U0819173	
2	KIT, MOTOR 10-rpm 115v	U0818616	1
	KIT, MOTOR 10-rpm 230v	U0818617	
	KIT, MOTOR 50-rpm 115v	U0818618	
	KIT, MOTOR 50-rpm 230v	U0818619	
	KIT, MOTOR 75-rpm 115v	U0818620	
	KIT, MOTOR 75-rpm 230v	U0818621	
3	FAN, DOLPHIN-10 only	U0818564	1
	FAN, DOLPHIN-50/75	U0818565	
4	PUMP COVER	U0819143	1
ψ	PUMP COVER(CE)	U0819146	
5	TIMER 115v	U0818183	1
	TIMER 230v	U0818460	
6#	PUMP HEAD ASS'Y w/PAD	U8800651	1

ITEM	DESCRIPTION	PART#	QTY
7	SWITCH/ROCKER	U0817923	1
8	POWER CORD ASS'Y 115v	U0819187	1
	POWER CORD ASS'Y 230v	U0819188	
ψ	POWER CORD ASS'Y 230v(CE)	U0819191	
9	POTENTIOMETER ASS'Y	U0818180	1
10	KNOB	U0817635	1
11	STRAIN RELIEF	L9900700-000	1
ψ	STRAIN RELIEF(CE)	J35762	
13	COLLAR, PERI HEAD	U0819132	2
14	SCREW, #10-32 x .68'lg.	U0817942	3
15	SCREW, #8-18 x 1.0'lg	L9806200-188	6
16	SCREW, #6-32 x .25'lg.	U0812955	1
21	LEAD ASS'Y, YELLOW	U0817630	1
22	LEAD ASS'Y, BLACK	U0819189	1
23	TAPE, DBLE. SIDED	U0020522	1'
25	HEAD TUBE, PERI φ.44-NOR	U0817926	1
26	HOSE CLAMP	U0817742	2
27	TUBE COLLAR	U0817123	2
29	INJECTION FITTING	U8800712	1
30*	STRAINER ASS'Y	J60552WT	1
31	STRAINER WEIGHT	L9906700-000	REF
32	TUBING 1/4" x 20'	U8800431	1
33+	KIT, HEAD TUBE φ.44-NOR	U8800637	REF
34ψ	BRACKET, PUMP MOUNTING	U0819178	1
35ψ	SCREW, #10-32 x .25'-lg.	U0811205	2
36	LEAD ASS'Y, Y-CONN	NC970015-000	1

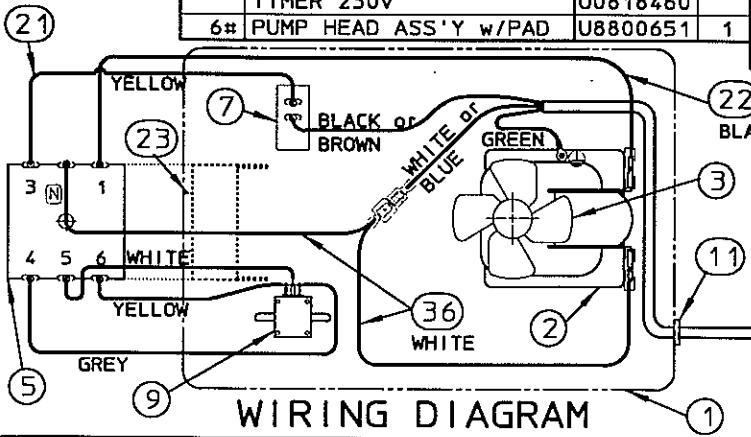

WIRING DIAGRAM

= INCLUDES ITEMS #6a thru 6d.
 + = INCLUDES TWO COLLARS (ITEM #27).
 * = INCLUDES WEIGHT (ITEM #31).
 ψ = USED ON 'CE' APPROVED PUMPS.

NOTES: 1. MOTOR KITS (ITEM #2) ALSO INCLUDE ITEMS #3, #16, #21, AND #22.
 2. ALL WIRES MUST BE PLACED and/or SECURED TO CLEAR FAN BLADES (ITEM #3).
 3.

US COLORS	WIRING	EURO COLORS
WHITE	= NEUTRAL	= BLUE
BLACK	= LINE	= BROWN
GREEN	= EARTH	= GREEN w/ YELLOW.

SEE NOTE 3. U0818236, D/8

KOPkit

Keep-On-Pumping kits that can save you time and money

When you need a part, you've got it! A KOPkit can help you cut downtime and put you back in business fast. Use KOPkits for preventative maintenance also, to ensure continuous high performance from your Pulsafeeder metering pump.

Save money too, by buying parts in KOPkits instead of ordering individual parts.

KOPkits are available for the CHEM-TECH Series 99X, Series 100, Series 200 and Series CTP; Mec-O-Matic Stingray Series and Dolphin Series; and all PULSAtron metering pumps.

FOR DIAPHRAGM PUMPS:

A typical KOPkit includes Pump Head assembly with Valve, Diaphragm, Head Screws, Washers and an exploded view assembly drawing.

FOR PERISTALTIC PUMPS:

A typical KOPkit includes Pump Head assembly with Tube, Retaining Clamps, Hose Clamps and an exploded view assembly drawing.

HOW TO ORDER:

PULSAtron (all models) - The KOPkit number will start with the letter "K", followed by the head size (4th digit of the pump model number) and the liquid end code (the 7th, 8th, 9th and 10th digits of the pump model number). The KOPkit for pump model number LB04SA-PTC1-XXX would be K4PTC1.

CHEM-TECH Series 99X, 100 & 200 - The Series 100 & 200 KOPkit number will start with "KX100-" followed by the liquid end code (the 7th, 8th, 9th and 10th digits of the pump model number). The KOPkit for pump model number X240-XD-BAAAXXX would be KX100-BAAA. The KOPkit for all Series 99X pumps is KX100-AAAA.

CHEM-TECH Series CTP - The KOPkit number will start with "NCK" followed by the 4th, 5th, 6th, 9th, 10th, 11th and 12th digits of the pump model number. The KOPkit for pump model number CTPD4HSA-PAP1-XXXXX is NCKD4HPAP1.

Mec-O-Matic Stingray Series - The KOPkit number for the Stingray Series is KUSR_-BCAK with the 3rd digit of the pump model number placed in the blank spot. The KOPkit for pump model number US210XA-BCAKXXX is KUSR2-BCAK.

Mec-O-Matic Dolphin Series - The KOPkit number for the Stingray Series is KUDXX-L_AU with the 8th digit of the pump model number placed in the blank spot. The KOPkit for pump model number UD50-XA-LSAUXXX is KUDXX-LSAU.



technology
innovation diversity
excellence