

MODEL 8170

Special Flange-Mounted Model
for Chrysler Marine Engine
Series M-46-4 M-47-4

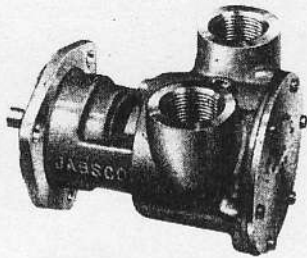

FEATURES

- BODY**
BRONZE CONSTRUCTION
- IMPELLER**
SPECIAL NEOPRENE COMPOUND
- SHAFT**
316 STAINLESS STEEL
- SHAFT SEAL**
MECHANICAL LIP TYPE
- BEARINGS**
BALL BEARING

3/4" I.P.T. PORT SIZE

Approx. wt. 7 lbs.

INSTALLATION DRAWING

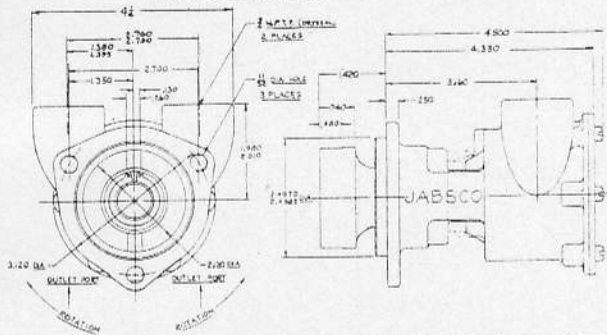

EXPLODED VIEW

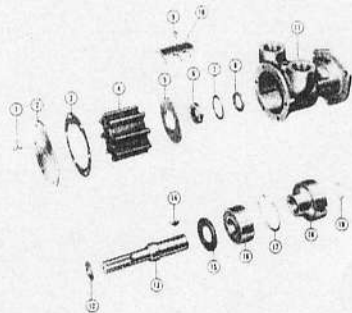

PARTS LIST

KEY	DESCRIPTION	QTY.	PART NUMBER
1	Screws—End Cover	6	SP 1003-01
2	End Cover	1	8175
3	Gasket	1	3101
4	Impeller	1	920-08
5	Wearplate	1	4156
6	Seal	1	SP 2700-06
7	"O" Ring	1	SP 2000-21
8	Spacer	1	3166
9	Screw—Cam	1	SP 1004-11
10	Cam	1	3255
11	Body	1	8174
12	Slinger	1	3286
13	Shaft	1	8177
14	Key	1	SP 1402-06
15	Bearing Seal	1	913
16	Ball Bearing	1	SP 2600-06
17	Retaining Ring	1	SP 1701-185
18	Coupling	1	8176
19	Retaining Ring	1	SP 1700-247

OPERATING INSTRUCTIONS

MODEL 8170

1. **INSTALLATION**—Care should be taken that the intake and discharge piping of the engine corresponds with the proper port markings on the pump.
2. **DRIVE**—Direct.
3. **SPEEDS**—Pump is designed to operate through the entire engine range.
4. **SELF-PRIMING**—JabSCO Pumps will operate satisfactorily at low as well as high speeds. Be sure suction lines are air tight.
5. **RUNNING DRY**—Impeller depends on liquid pumped for lubrication. **DO NOT RUN DRY** for more than 30 seconds. Lack of liquid will burn the impeller.
6. **PRESSURES**—Excessive back pressure due to scale and rust deposits in the water passages will reduce the flow and cause engine to overheat.
7. **TEMPERATURES**—Impeller specially compounded to operate through the range of 45° - 180° F. For temperatures of 27° - 45° F. use .09 impeller.
8. **FREEZING WEATHER**—Drain unit by loosening end cover plate. For closed systems, use one of the following anti-freeze compounds: Atlas "Permaguard", DuPont "Zerex", Dow Chemical "Dowguard", "Pyro", or "Telar". **Do not use** petroleum based anti-freeze compounds.
9. **IMPELLER REPLACEMENT**—Remove end cover. Withdraw impeller by grasping impeller hub with pliers.
10. **GASKET REPLACEMENT**—Always use standard pump part. A thicker gasket will reduce priming ability. A thinner gasket will cause impeller binding.
11. **CAM REPLACEMENT**—Coat top surface of new cam and cam screw threads with permatex #1 or equivalent sealing compound before installing.
12. **SPARE PARTS**—Avoid costly shut downs by always having a JABSCO Service Kit on hand.

SERVICE KITS

MINOR SERVICE KIT—For "onboard" repairs — includes impeller, seal, gaskets and screws.

MAJOR SERVICE KIT—For major pump overhaul — includes all parts except body.

PART NUMBER	DESCRIPTION
8459	Minor Service Kit
8453	Major Service Kit

WARRANTY: All products of the company are sold and all services of the company are offered subject to the company's warranty and terms and conditions of sale, copies of which will be furnished upon request.

JABSCO® PUMP COMPANY

1485 DALE WAY • COSTA MESA, CALIF.