

**JABSCO® PUMPS**  
Self-Priming Pumps

**MODELS:** 6350-0001 6 VOLT  
6360-0001 12 VOLT  
6370-0001 24 VOLT  
6380-0001 32 VOLT  
Product Data

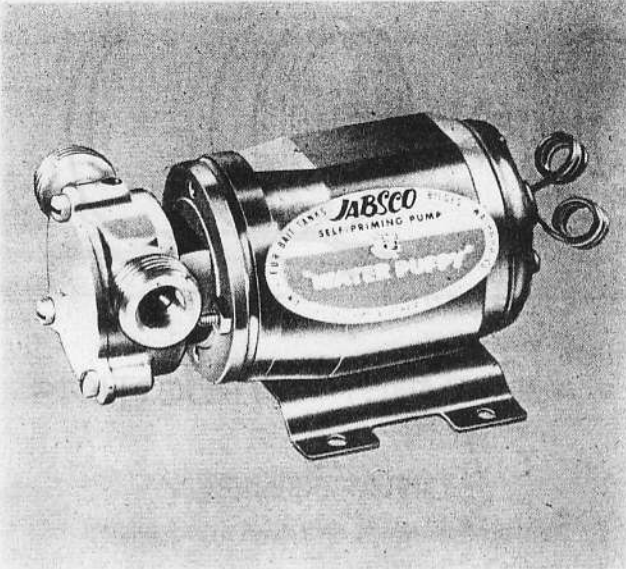

**"WATER PUPPY"**

**DESIGN FEATURES**

- Body: Bronze
- Impeller: Jabasco Nitrile Compound
- Seal: Lip Type
- Ports: 3/8" Pipe Thread Internal  
3/4" Garden Hose External
- Motor: 1/12 H.P., Enclosed  
stainless steel shaft
- Weight: 5 1/2 lbs. (approx.)
- Dimensions: 3" High, 6 3/8" Long, 4" Wide

**APPLICATIONS AND OPERATING INSTRUCTIONS**

Ideal for Bilge Pumping, Bait Tank Wash Down. For larger boats, a variety of higher capacity Jabasco Bilge Pumps are available.

1. **INSTALLATION** — Pump may be mounted in any position without loss of efficiency, however, it is suggested that the pump head be down if vertical mounting is desired. DC motor turns clockwise looking at pump end cover, intake port is on the right, discharge left.
2. **WIRING** — Use stranded wire. DO NOT use lamp cord or other substitute. Consult wire size table at right for proper wire size.
3. **SELF-PRIMING** — Pump will produce a suction lift approaching 10 ft. when dry and a lift to 20 ft. when primed. BE SURE SUCTION LINES ARE AIR TIGHT.
4. **RUNNING DRY** — Unit depends on liquid pumped for lubrication. DO NOT RUN DRY for more than 30 seconds. Lack of liquid will burn the impeller.
5. **CAUTION** — Do not pump solvents, thinners, or gasoline. If corrosive fluids must be handled, pump life will be prolonged if flushed with water after each use or after each work day. MOTOR IS NOT EXPLOSION PROOF.
6. **PRESSURES** — For normal operation, pressure should not exceed 20 feet of head.

7. **TEMPERATURES** — Impeller supplied in pump is recommended for liquid temperatures of 45°-160°.
8. **FREEZING WEATHER** — Drain unit by loosening end cover plate.
9. **SPARE PARTS** — Avoid costly shut down by always having a 90061-0003 Service Kit on hand.

NOTE: Motor will APPEAR to be running hot. The NORMAL operating temperature is 180°.

**MINIMUM WIRE SIZES**

Connection Length Between Battery and Motor	6350-0001 6 V.	6360-0001 12 V.	6370-0001 24 V.	6380-0001 32 V.
1-10 ft.	#8	#14	#16	#16
11-20 ft.	#6	#12	#16	#16
21-30 ft.	Not Rec.	#10	#12	#16

CAUTION: Use only multi-strand copper wire in size recommended. DO NOT use ordinary lamp cord or other substitutes.

**AMPERE DRAW**

Model	6350-0001 6 V.	6360-0001 12 V.	6370-0001 24 V.	6380-0001 32 V.
Amp. Draw (Approx.)	14	7	4	3
Fuse Size	15	9	5	5

Models 6370-0001 - 24 v., 6380-0001 - 32 v.

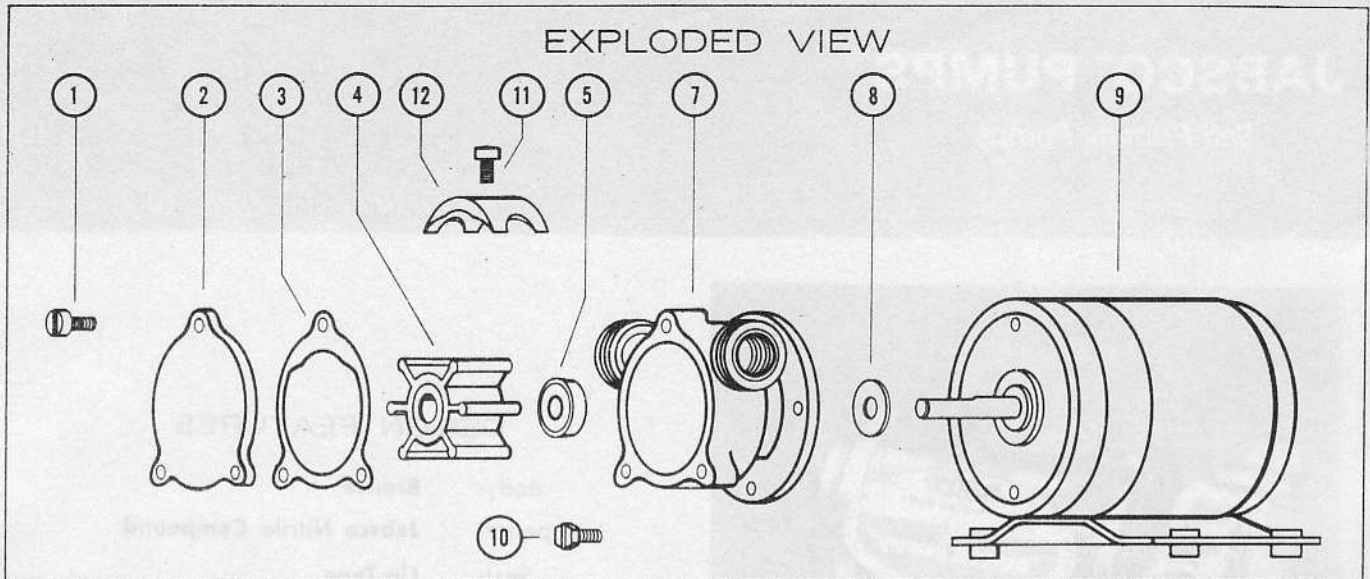

## PARTS LIST

KEY	PART NUMBER	DESCRIPTION	QTY. REQ.
1	91004-0090	Screw (End Cover)	3
2		End Cover	1
	6355-0000	Model 6350-0001	
	6365-0000	Model 6360-0001	
	6375-0000	Model 6370-0001	
	6385-0000	Model 6380-0001	
3	1985-0010	*Gasket	1
4	6303-0003	*Impeller	1
5	93000-0010	*Seal	1
7	6944-0000	Body	1
8	6342-0000	Slinger	1
9		Motor	1
	98012-0010	Model 6350-0001 6v.	
	98012-0020	Model 6360-0001 12v.	
	98012-0030	Model 6370-0001 24v.	
	98012-0040	Model 6380-0001 32v.	
10	98019-0060	Screw (Pump to Motor)	2
11	91002-0010	Screw (Cam)	1
12	2907-0000	Cam	1
	90061-0003	Service Kit	
	7440-0001	Replacement Pump Head	

\*Parts included in Service Kit

## HEAD CAPACITY TABLE

Lbs. per Sq. In.	Ft. of Water	GPM
4.3	10	4.6
8.7	20	3.7
13.0	30	1.7

Table shows approximate Head-Flow for new pump in U.S. gallons per minute.

## ASSEMBLY INSTRUCTIONS

### DISASSEMBLY

1. Remove screws, end cover and gasket.
2. Withdraw impeller.
3. Loosen and remove two slotted hex screws, which attach body to motor.
4. Tap body lightly between ports and remove body from motor.
5. Deform seal and remove from body cavity.

NOTE: Do not tamper with or disassemble motor.

### ASSEMBLY

1. Lubricate seal. Deform seal and install in cavity with open side of seal facing impeller.
2. Lubricate motor shaft and install body on motor.
3. Lubricate impeller bore and aligning ding in impeller with flat on motor shaft, install impeller.
4. Install gasket, end cover and screws.

# JABSCO PRODUCTS **ITT**

Fluid Handling Division, International Telephone and Telegraph Corporation, 1485 Dale Way, Costa Mesa, California 92626