

JABSCO®**Model 45740-0000****115 Vac ROTARY VANE PUMP
FEATURES**

- Body:** Bronze
- Rotor:** Reinforced Liquid Crystal Polymer
- Vanes:** Reinforced Liquid Crystal Polymer
- Seal:** Lip type, Nitrile
- Motor:** 1/8 HP, 115 Vac-60 Hz T.E.N.V. 3450 RPM with Thermal Overload Protection and 6' Cord
- Ports:** 1 Inch External Hose Barb
1/2 Inch Internal Pipe Threads
- Heights:** 5³/₄ Inches
- Length:** 9³/₄ Inches
- Width:** 5⁵/₈ Inches
- Weight:** 14¹/₂ Pounds



Model 45740-0000

WARNING

Explosion hazard. Do not pump gasoline, solvents, thinners or other flammable liquids. To do so can cause an explosion resulting in injury or death.

WARNING

Explosion hazard. Do not use where flammable vapors are present. To do so can cause an explosion resulting in injury or death.

APPLICATION

The Jabsco rotary vane pump is ideal for pumping light oil or transferring diesel fuel. The rotor and vanes are not affected by petroleum products. It is self-priming with a suction lift of up to five feet and can pump against a discharge head of up to thirty feet. The motor is rated for continuous duty in applications with a total system head no greater than thirty feet and when pumping liquids with a similar viscosity to diesel fuel. When pumping light oils, the duty cycle should be no longer than thirty minutes.

INSTALLATION

The 115 Vac vane pump can be used as a portable pump or mounted permanently in pumping system. It can be mounted on any flat surface. However, it is advisable to mount it so the motor shaft remains horizontal. The pump head may be rotated on the motor in 90° increments to accommodate plumbing connections as needed or to change the direction of flow.

PLUMBING CONNECTIONS

Pump ports have external 1" hose barb and internal 1/2" pipe threads. Use hose that does not kink when bent and with sufficient wall thickness to prevent collapse when used on suction side of pump. Hoses should be routed so that some fluid will be retained in pump body to wet the rotor and vanes. Wetting the rotor and vanes aids in priming. Use a strainer on the intake hose if trash or solids are present in the fluid being pumped. Diesel fuel and used oil may contain debris or contaminants which require the use of a fine mesh screen strainer. **ALL HOSES MUST HAVE AIRTIGHT CONNECTIONS TO ENABLE FAST PRIMING.**

PERFORMANCE DATA

PSI	TOTAL HEAD		CAPACITY	
	FEET	METRES	GPM	l/MIN
2.1	5	1,5	8.5	32
4.3	10	3,0	8.2	31
8.7	20	6,1	7.8	30
13.0	30	9,1	7.4	28

Table shows approximate Head-Flow for new pump pumping diesel fuel. If pumping water, flow rates are reduced approximately 20%.

EXPLODED VIEW

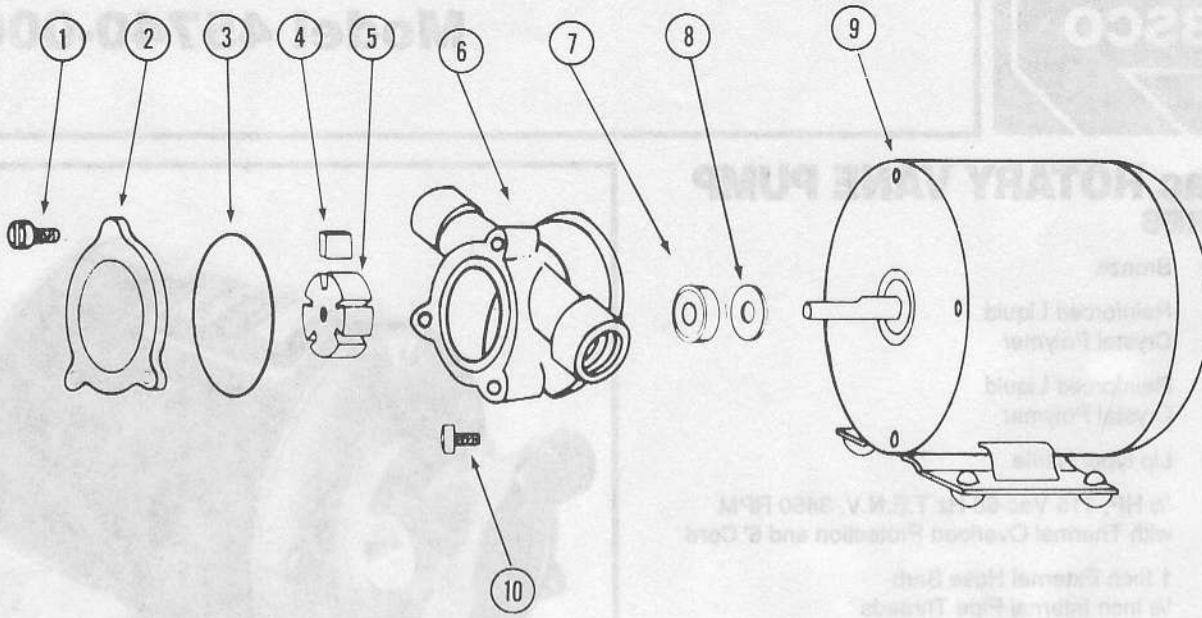

KEY	PART NUMBER	DESCRIPTION	QTY. REQ.
1	91004-0090	Screw (End Cover)	3
2	18753-0070	*End Cover	1
3	18753-0071	*O-Ring	1
4	18753-0072	*Vaness (set of 5)	1
5	18753-0073	*Rotor	1
6	18753-0135	Body	1
7	1040-0000	*Seal	1
8	6342-0000	Slinger	1
9	18753-0082	Motor	1
10	98019-0020	Screw (Pump to Motor)	2
	90200-0000	Service Kit	

* Parts contained in Service Kit.

OPERATION

Rotary Vane pumps must NOT be run dry, as the pumped liquid is the lubricant for the rotor and vanes. Observe the outlet and shut off pump as soon as liquid stops flowing.

The pump cannot run against a closed outlet such as encountered when using a garden hose type shut-off nozzle. Pressure for normal operation should not exceed 30 feet of head (13 PSI). Excessive pressures will cause motor to overheat tripping the thermal overload protector.

Temperature of pumped liquid may range from 45° - 165°F (7° - 74°C). When pumping engine oil, run engine long enough to heat oil to about 150°F (66°C).

WARNING



Fire Hazard. Do not pump volatile liquids with a flash point below 100°F (38°C). Doing so may cause an explosion or fire resulting in injury or death.

NOTE: Diesel fuel has a flash point of 100°-190°F (43°-88°C).

THE PRODUCT DESCRIBED HEREIN IS SUBJECT TO THE JABSCO ONE YEAR LIMITED WARRANTY, WHICH IS AVAILABLE FOR YOUR INSPECTION UPON REQUEST.

DISASSEMBLY

1. Remove end cover screws, end cover and O-ring.
2. Withdraw rotor and vanes.
3. Loosen and remove two slotted hex screws, which attach body to motor.
4. Tap body lightly between ports and remove body from motor.
5. Press seal from the rotor side of the body out of the seal bore.

ASSEMBLY

1. Press seal from the motor side of the body into the seal bore with lip pointing toward the rotor bore.
2. Lubricate motor shaft and install body on motor.
3. Aligning flat in rotor with flat on motor shaft, install rotor. Install vanes in vane slots of rotor.
4. Install O-ring, end cover and end cover screws.

MAINTENANCE

Periodic cleaning of rotor and vanes will ensure proper pump performance and extend rotor/vane life.

In most applications, pump vanes should last about 250 hours and the rotor should last about 500 hours. Timely replacement of vanes and rotor will maintain maximum performance. The seal should be expected to last about 500 hours in most applications.

Frequent cleaning of intake strainer (when used) will minimize intake suction and prolong pump life.

If pump is to be in freezing temperatures, drain by loosening end cover screws.

ITT Jabsco

ITT Fluid Technology Corporation
1485 Dale Way, P.O. Box 2158, Costa Mesa, CA 92628-2158
Tel: (714) 545-8251; Fax: (714) 957-0609
Bingley Road, Hoddesdon, Hertfordshire EN11 OBU England
Tel: 0992-467191; Tlx: 263251 G; Fax: 0992-467132