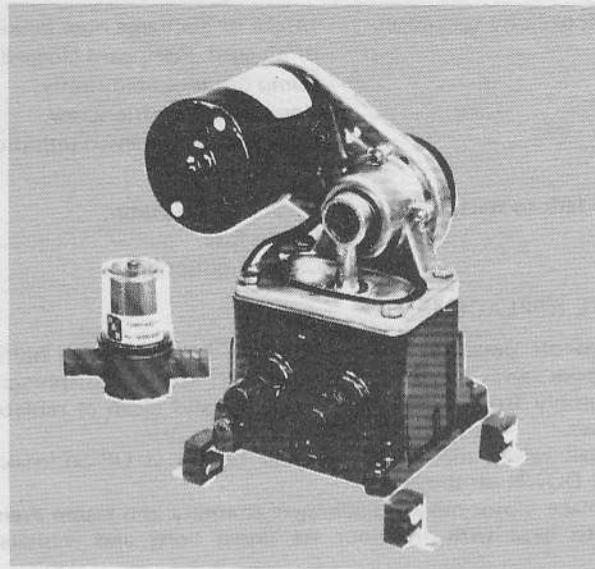

PAR™**ELECTRIC SHOWER DRAIN PUMP****MODEL 36251-Series***PRODUCT DATA***INSTALLATION****MOUNTING**

Mount upright in a dry location (above highest bilge water level) on a solid surface. Adjust belt tension for 1/4 inch play between pulleys.

PLUMBING

For intake and discharge use 3/4" I.D. non-collapsible hose. Keep intake and discharge lines free of kinks and restrictions. Install the pumpguard supplied (PAR Model 36200-0000) in the intake line from the sump to protect pump from debris. Use a 3/4" thru-hull fitting (PAR Model 59431-0000) for discharge.

WIRING

Wire pump in a circuit independent of all other electrical fixtures. Use stranded copper wire. Install fuse in positive lead. See table for recommended wire and fuse size. See diagram for wiring connections. Use a 10 amp-rated switch. After installation, it is recommended that voltage be checked at the motor terminals with motor operating under full load and all other appliances in the circuit operating. Voltage should not be less than 90% of rated motor voltage.

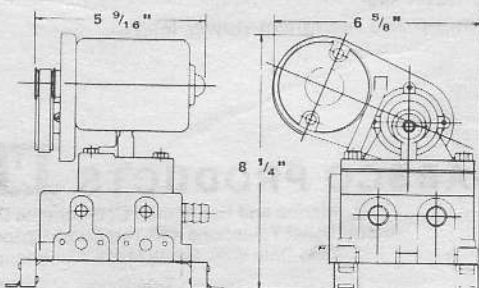
DIMENSIONAL DRAWING**FEATURES**

- Self-Priming
- Diaphragm Design Allows Dry Running
- Quiet Operation
- Built-in Hydraulic Pulsation Dampener
- Permanently Lubricated Ball Bearings on Shaft and Connecting Rod
- Corrosion Resistant Materials Throughout for Fresh or Salt Water Service
- Meets USCG Electrical Standards

SPECIFICATIONS

| | U.S. GPM | Liters/Min. | Imp. GPM |
|-------------------------|-------------------|-------------|----------|
| Open Flow | 2.0 | 7.5 | 1.7 |
| Vert. Dry Suction Lift: | 5 Feet (1.5M) | | |
| Ports: | 3/4" Slip-on Hose | | |
| Weight: | 8 Lbs. (3.6 kgs.) | | |

STANDARD MODELS

| Model | Voltage | Amperage (Nominal) |
|------------|---------|--------------------|
| 36251-0000 | 12 VDC | 5 |
| 36251-0010 | 24 VDC | 3 |
| 36251-0020 | 32 VDC | 2 |

MAINTENANCE

WINTER STORAGE: When possible it is preferred that the complete pump be removed and stored in a warm dry place. If this is not possible the pump must be completely drained, hoses removed and pump run until all water is expelled.

WIRE AND FUSE SIZE

| Wire Length Between Battery and Motor | Model 36251-0000 | Model 36251-0010 | Model 36251-0020 |
|---------------------------------------|------------------|------------------|------------------|
| | 12 Volt | 24 Volt | 32 Volt |
| 1 - 25 feet | 14 AWG | 14 AWG | 16 AWG |
| 25 - 50 feet | 12 AWG | 14 AWG | 14 AWG |
| Fuse Size: Slo-Blo Standard | 5 AMP | 3 AMP | 2 AMP |
| | 7 AMP | 4 AMP | 3 AMP |

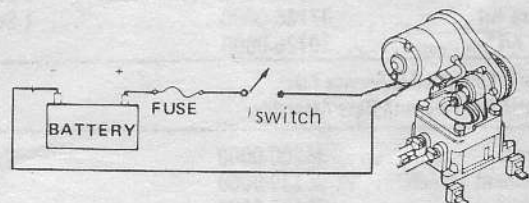
WIRING DIAGRAM**JABSCO PRODUCTS ITT**

Form 43000-0342 11-79

MODEL 36251-SERIES

SERVICE

EXPLODED VIEW

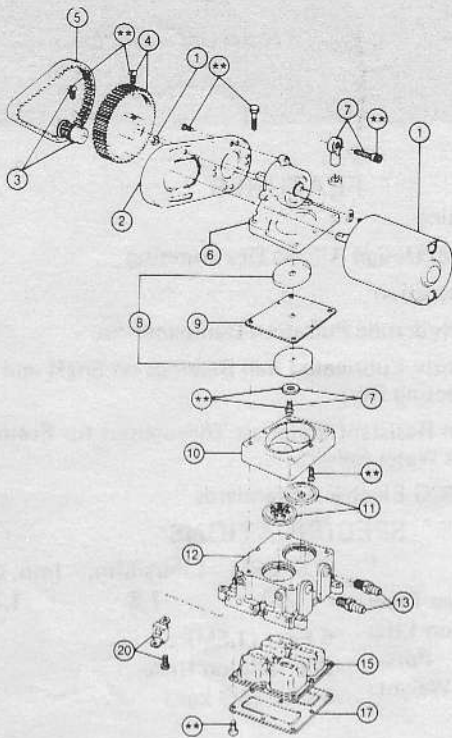

**Indicates items included in Hardware Kit (Key 21).

PARTS LIST 36251-Series

| Key | Part Description | Part Number | Qty |
|-----|----------------------------|--------------|-------|
| 1 | Motor Kit 12 Volt D.C. | 30209-0000 | 1 |
| 1 | Motor Kit 24 Volt D.C. | 30200-0010 | 1 |
| 1 | Motor Kit 32 Volt D.C. | 30200-0020 | 1 |
| 2 | Motor Mount | 34628-0000 | 1 |
| 3 | Small Pulley | 37169-0000 | 1 |
| 4 | Large Pulley | 37171-0000 | 1 |
| 5 | Belt | 30022-0000* | 1 |
| 6 | Jack Shaft Assembly | 35689-0000 | 1 |
| 7 | Connecting Rod Kit | 37173-0000 | 1 |
| 8 | Diaphragm Plates | 35503-0000 | 2 |
| 9 | Diaphragm | 30015-0000* | 1 |
| 10 | Retainer | 35173-0000 | 1 |
| 11 | Valve Set (Inlet & Outlet) | 30004-0000* | 1 Set |
| 12 | Base Assembly† | 35620-0000† | 1 |
| 13 | Ports (Inlet & Outlet) | 37175-0000† | 1 Set |
| 15 | Pulsation Dampener | 37178-0000*† | 1 |
| 17 | Bottom Plate | 35686-0000† | 1 |
| 20 | Vibration Pad Kit | 37180-0000† | 1 Set |
| 21 | Hardware Kit | 37166-0000 | 1 Set |
| | Service Kit* | 30126-0000 | |

*Indicates Parts Contained in Service Kit.

†Indicates Parts Supplied with Base Assembly.

| | |
|--------------------|------------|
| Pumpgard | 36200-0000 |
| Replacement Screen | 36139-0000 |
| "O"-Ring Seal | 36403-0000 |

TROUBLE SHOOTING

| Problems | Causes |
|---------------------------|---|
| Loss of suction to pump. | - Air leak in suction line or pumpgard. - No water in sump. - Intake hose kinked or plugged. - Fouled intake or discharge valve. - Ruptured diaphragm. |
| Rough or noisy operation. | - Intake or discharge hose kinked or plugged, Pumpgard clogged. - Pump not mounted firmly. - Loosened eccentric screw. - Ruptured or collapsed pulsation dampener. |
| Pump fails to start. | - No voltage to pump. - Blown fuse. - Clogged outlet line. |

VALVE REPLACEMENT

1. Turn off power to pump. Remove four tie down bolts.
2. Expose valves by lifting jack shaft and attached diaphragm assembly from pump base. Remove and clean or replace valves.
3. Install valves, making sure rubber flapper is UP on intake and DOWN on discharge.
4. Replace motor-mount-diaphragm assembly and fasten evenly to base with the four tie down bolts and washers.

DIAPHRAGM AND CONNECTING ROD REPLACEMENT

1. Turn off power to pump. Remove four tie down bolts.
2. Lift jack shaft and the attached diaphragm assembly from pump base.
3. Remove two diaphragm retainer screws and the bottom diaphragm retainer.
4. Remove eccentric screw. Remove connecting rod and diaphragm from the top diaphragm retainer, then unscrew bolt to separate diaphragm and plates.
5. Check diaphragm for cuts and cracks. Check rod assembly bearing for excessive wear. Replace if badly worn.
6. Loosely reassemble diaphragm, diaphragm plates, connecting rod spacer and diaphragm bolt onto connecting rod. Firmly secure connecting rod to jack shaft with the eccentric screw. Secure diaphragm to upper diaphragm retainer with the bottom diaphragm retainer and two screws.
7. Tighten connecting rod bolt.
8. Replace motor-mount-diaphragm assembly and fasten evenly to base with the four tie down bolts and washers.

PULSATION DAMPENER REPLACEMENT

1. Disconnect power leads from pump and remove from mount.
2. Remove nine bottom plate screws and the bottom plate. Pull out and replace pulsation dampener.
3. Replace bottom plate and screws. Tighten evenly to ensure an air and water seal.
4. Reinstall pump and reconnect power leads.

JABSCO PRODUCTS **ITT**

Marine and Recreation Components Division
International Telephone and Telegraph Corporation
1485 Dale Way, Costa Mesa, California 92626

Telephone: (714) 545-8251