

DESIGN FEATURES

- Body: **Bronze**
- Impeller: **Jabscos Neoprene Compound**
- Shaft: **Stainless Steel**
- Shaft Seal: **Carbon-Ceramic Face Type**
- Ports: **1 1/4" Hose Connection**
- Weight: **5 lbs. (approx.)**

Application

Marine Engine Cooling

For Eaton Engine Models :165, 200 and 210 (1967 and early 1968)

Replaces Eaton Pump #1103940

Dimension Drawing

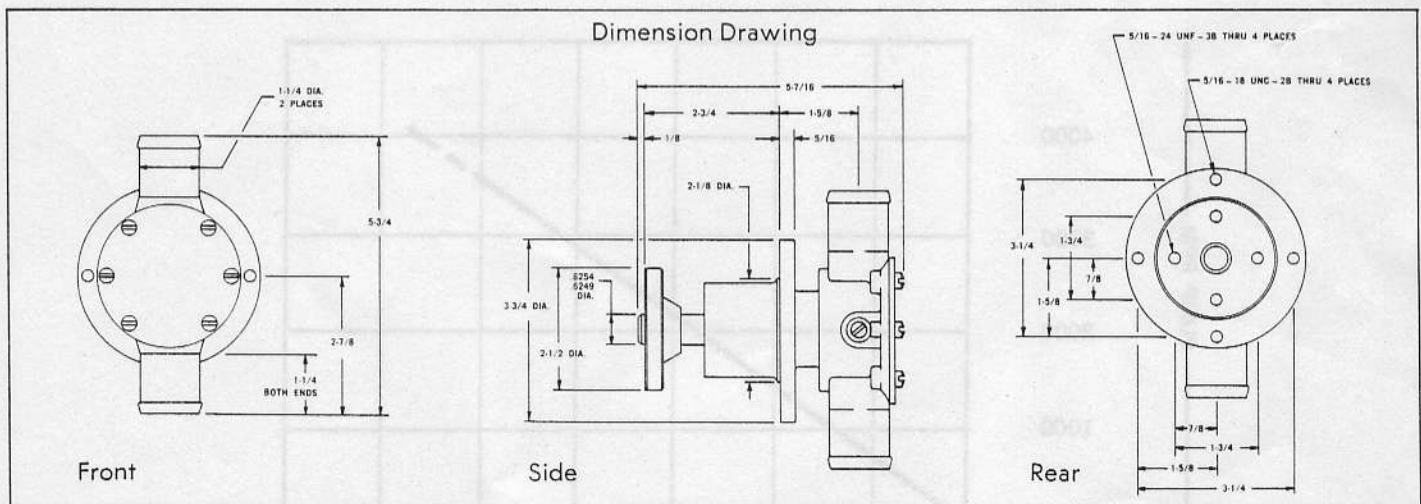

INSTALLATION INSTRUCTIONS

1. Install pump on mounting bracket with ports in same position as original pump. Make sure inlet port lines up with inlet hose (pump may be rotated 180° to obtain correct position). Complete installation by mounting pulley and connecting inlet and outlet hoses.

OPERATING INSTRUCTIONS

Pump will self prime at low or high speeds. Make sure scoop and inlet line are clear and all connections air tight. Do not run pump dry for more than 30 seconds. Lack of water flow may damage impeller.

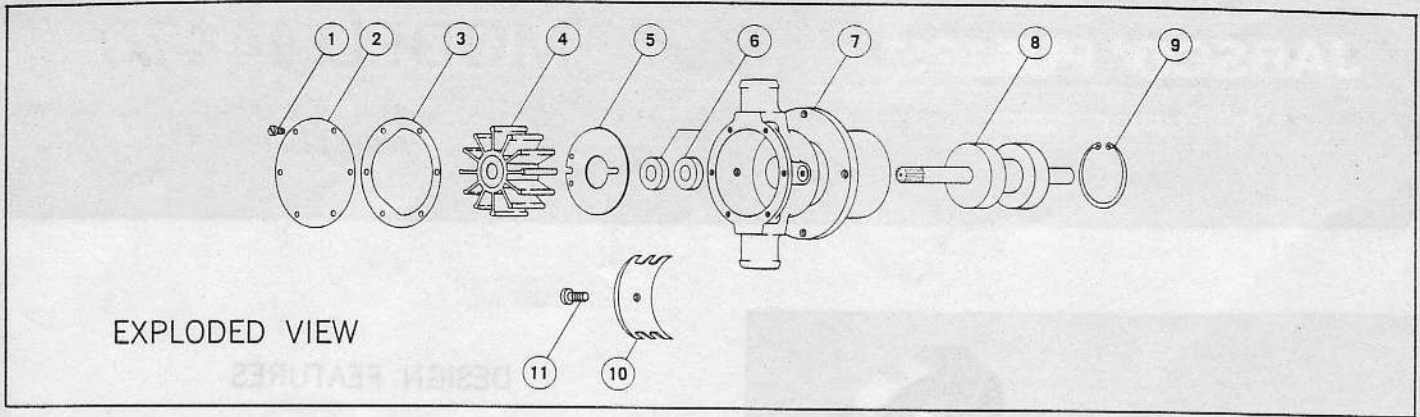

EXPLODED VIEW

SERVICE INSTRUCTIONS

Impeller replacement: Remove end cover and gasket. Pull impeller out by grasping hub or blades with pliers. Replace impeller, gasket and end cover. A light coating of grease in impeller bore will aid priming on dry start up. (Use correct Jabsco gasket, a thicker or thinner gasket may cause impeller damage).

Major Repair: Remove pump from engine to replace seal, bearings or shaft. Completely disassemble pump, take out retaining ring (Key 9) to remove shaft-bearing assembly (Key 8). Replace all worn parts and reassemble. Note: Use Permatex #2 or equivalent on top surface of cam, cam screw threads and on O.D. of brass seal case to insure proper seal. Be sure seal faces are clean and free of dirt.

PARTS LIST

Key	Description	Part No.	Qty.
1	Screw (Endcover)	SP1003-09	6
2	Endcover	14475	1
3	*Gasket	8641	1
4	*Impeller	3085	1
5	Wearplate	8493	1
6	*Shaft Seal	SP6080-08	1
7	Body	14474	1
8	Shaft-Brg. Assy.	14476	1
9	Retaining Ring	SP1700-284	1
10	Cam	8528	1
11	Screw (Cam)	SP1003-11	1
—	Service Kit	SK117-12	—

*Parts supplied in Service Kit

PUMP FLOW CHART

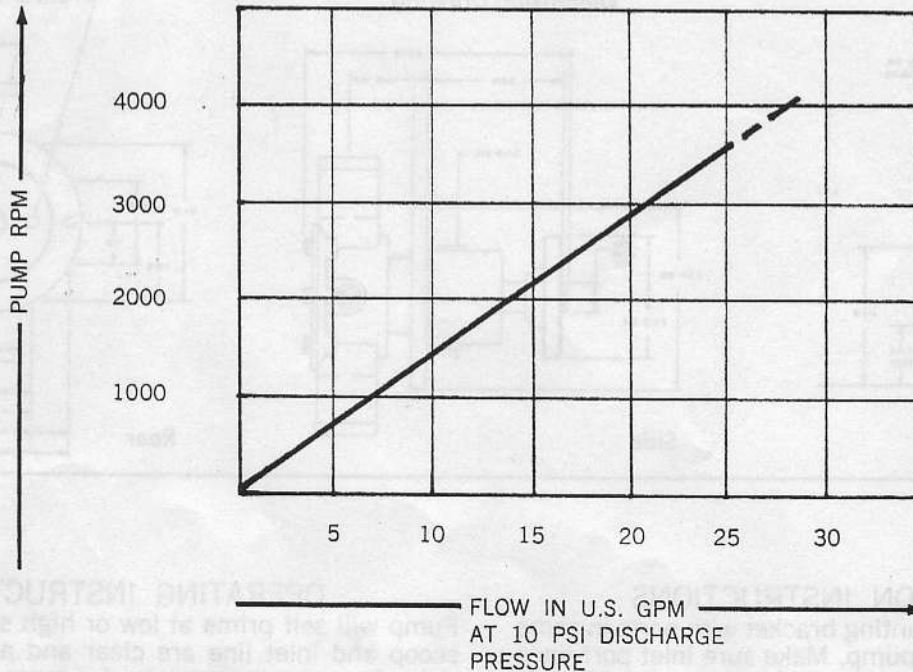

JABSCO PUMPS

Fluid Handling Division, International Telephone and Telegraph Corporation, 1485 Dale Way, Costa Mesa, California 92626