

a xylem brand

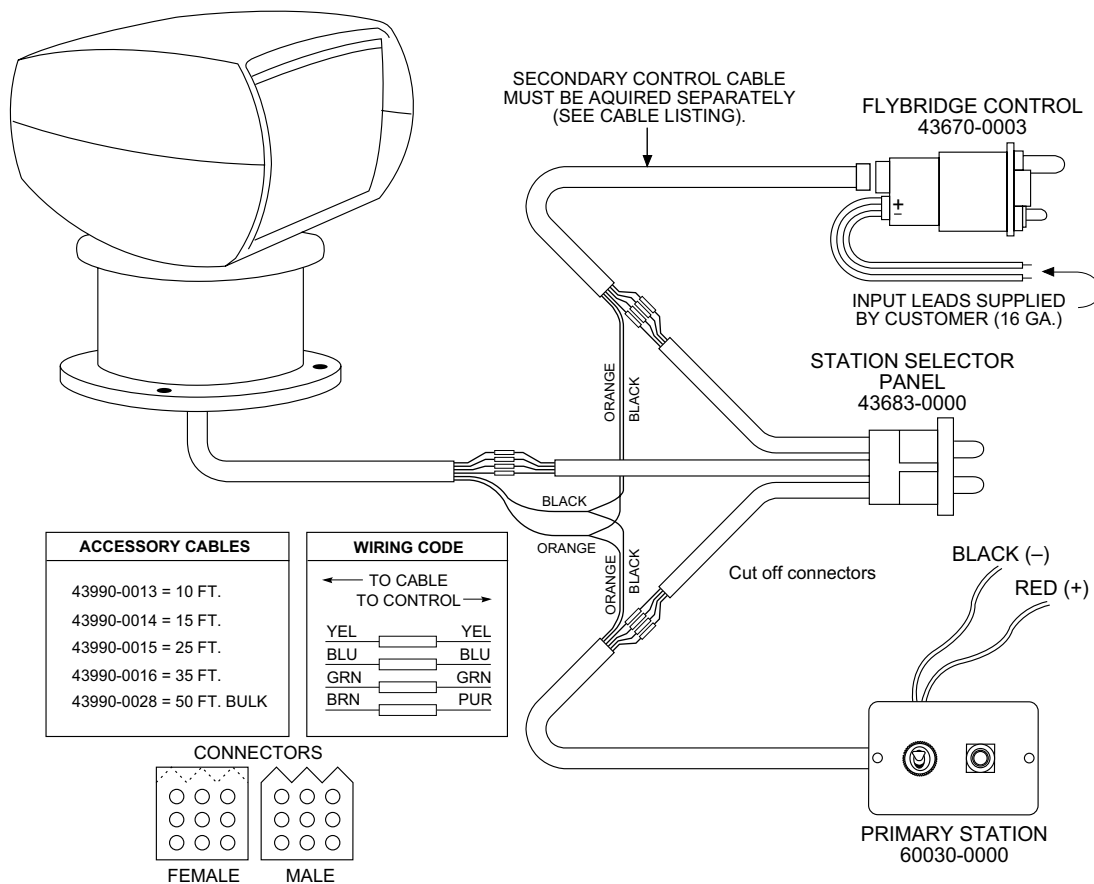

1. Install searchlight and primary control per product data sheet.
2. Install station selector panel (43683-0000) near (1 foot radius) primary control (flybridge or lower station).
3. Route secondary control cable from station selector panel to secondary control (cable must be acquired separately).
4. Install secondary control (43670-0003) by cutting a 2-5/8" diameter hole in flat surface where control is to be mounted. Use bedding compound or sealant to waterproof control mounting.
5. Wiring Connections:
  - Cut off female plug (see diagram) on secondary control cable, strip wires back.
  - Connect positive (+) power lead to red (+) wire and negative (-) power lead to the black (-) wire on the primary control. Repeat with separate power leads to secondary control using the terminals provided.
  - Connect the orange and black wires from the light cable to the orange and black wires from both the primary and secondary controls.
  - Connect the remaining wires per the wiring code and diagram above.
6. Secure controls with self-tapping screws provided.

[www.xylemflowcontrol.com](http://www.xylemflowcontrol.com)

JabscO, 100 Cummings Center, Ste. 535-N, Beverly, MA 01915  
Tel: +1 978 281 0440 Fax: +1 978 283 2619

JabscO, Bingley Road, Hoddesdon, Hertfordshire, EN11 0BU  
Tel: +44 (0) 1992 450 145 Fax: +44 (0) 1992 467 132

NHK JabscO Co Ltd, 3-21-10, Shin - Yokohama Kohoku-ku, Yokohama 222  
Tel: +81 (0) 45 475 8906 Fax: +81 (0) 45 475 8908

JabscO GmbH, Oststraße 28, 22844 Norderstedt  
Tel: +49 (0) 40 53 53 73 0 Fax: +49 (0) 49 53 53 73 11

JabscO Italia, s.r.l., Via Tommaseo, 6, 20059 Vimercate, Milano  
Tel: +39 039 685 2323 Fax: +39 039 666 307

USA

UK

JAPAN

GERMANY

ITALY



a xylem brand