



500 Size Stainless Steel FIP Pedestal Pump

8/00

28630 Series

Stainless Steel Pedestal Pump

Features

- Self primes from dry up to 5.0 metres
- Flows up to 520 litres per minute
- Pressure up to 5.0 bar
- Handles hard or soft solids - max. 14mm dia
- Tolerates abrasive wear - replacable wearplate
- Non pulsating flow, proportional to speed
- Handles viscosities up to 50,000 centiPoise
- Minimal shear to thixotropic fluids
- Easy to service and maintain



Typical Applications

- Acids and alkalis, compounds, copper sulphate, methyls, alcohols.
- Industrial chemicals, resins, oils, fatty acids, brine.
- Detergents, soaps, hydrogen peroxide.
- Paints, dyes, inks, varnishes, laquers, solvents.
- Transfer, filling, recirculation and agitation, spillage return, spraying, coating, filtration.
- Viscous, shear-sensitive fluids, small hard and soft solids in suspension.

Specifications

Seal : Carbon / Ceramic mechanical face seal

Optional:

- Nitrile Lip seal on shaft sleeve

Seal Elastomer : Nitrile

Pump Head : Stainless steel 316, as-cast interior and exterior finish

End Cover : Stainless steel 316 grade

Shaft : Stainless steel 316 grade

Bearings : Greased ball bearings

Bearing Housing : Epoxy coated cast iron

Ports : 3" BSP external thread to BS21 (DIN2999)

Weight : 18kg

Model Range

Impeller options	Standard Pressure - Max. 2.0 bar		High Pressure - Max. 5.0 bar	
Elastomer option	3A Neoprene		3A Neoprene	
Temperature range	4°C to 65°C		4°C to 65°C	
Mechanical Seal Option				
Carbon/Ceramic			28630-2125	
Lip seal			28630-2425	

For models not listed above, consult distributor or factory

Note : it is not recommended to start the pump at extremes of the temperature range, impeller damage may occur

For Installation, Operating, Maintenance and Safety Instructions refer to form 43001-0543

⚠ WARNING Explosion hazard. Do not pump gasoline, solvents, thinners or other flammable liquids. To do so can cause an explosion resulting in injury or death.

⚠ WARNING Injury hazard. Exposed pulleys and belts can cause injury. Install shield around pulleys and belts. Stay clear while machinery is operating.

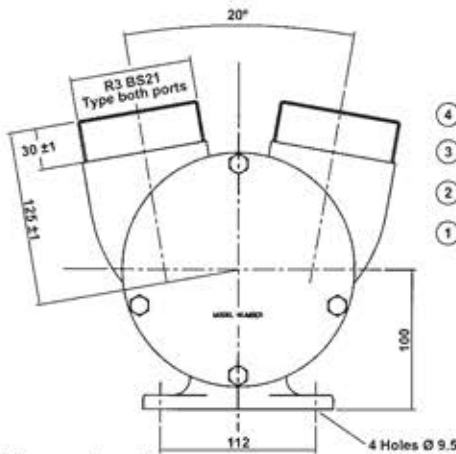

Dimensions in mm

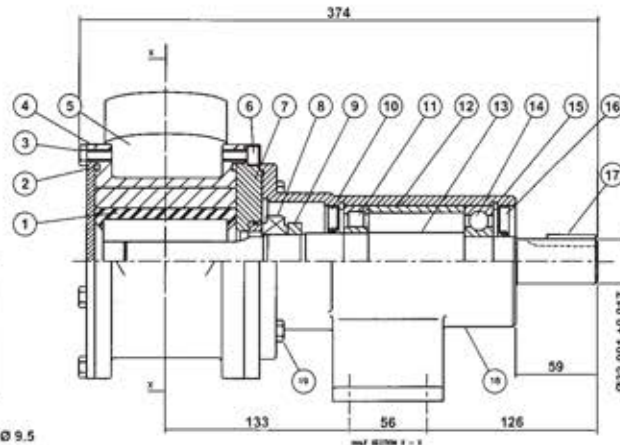

For performance data refer to the 500 size flexible impeller pump performance curves

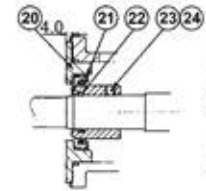

Lip Seal

Parts List

Key	Description	Qty	Part Number
1	Impeller* (Std Pressure)	1	8500-0005
	(High Pressure)	1	21899-0005B
2	O'Ring *	2	X2000-1213
3	Screw (Endcover)	4	X3001-209F
4	Endcover	1	23975-0000
5	Body	1	23974-2000
6	Screw (Wearplate)	4	X3007-209F
7	Wearplate	1	28635-0000
8	Seal Assembly *	1	22644-6000
9	Seal Spacer	1	28638-0000
10	Seal (Inbound)	1	SP2701-0912
11	Bearing (Front)	2	SP2601-23
12	Bearing Spacer	1	28643-0000
13	Shaft	1	28607-0000
14	Bearing (Rear)	2	SP2601-0460
15	Retaining Ring	2	SP1701-437
16	Seal (Outbound)	1	SP2701-0930
17	Key	1	X4000-487A
16	Washer	4	X3080-101F
18	Bearing Housing	1	28503-0000
19	Screw (Bearing Housing)	4	X3001-209F
	Washer (Bearing Housing)	4	X3080-101F
20	Wearplate	1	28666-0000
21	Lip Seal	2	SP2701-0915
22	O-Ring	1	X4020-237A
23	Seal Sleeve	1	28665-0011
24	Screw (Seal Sleeve)	2	X3009-092F

Parts marked * Contained in service kit

Spare Parts & Service Kits

Service Kit for Neoprene High pressure impeller only : SK315

Models with Neoprene impellers use Nitrile elastomers on seals and O-rings.

Other Available Options

Standard head kits, for close coupling to standard IEC motors.

Jabsco

USA

Jabsco
1485 Dale Way
Costa Mesa
CA 92628-2158

Tel : +1 714 545 8251
Fax : +1 714 957 0609

UK

Jabsco
Bingley Road
Hoddesdon
Hertfordshire, EN11 0BU

Tel : +44 (0) 1992 450 145
Fax : +44 (0) 1992 467 132

GERMANY

Jabsco GmbH
Oststraße 28
22844 Norderstedt

Tel : +49 (0) 40 53 53 73 0
Fax : +49 (0) 40 53 53 73 11