

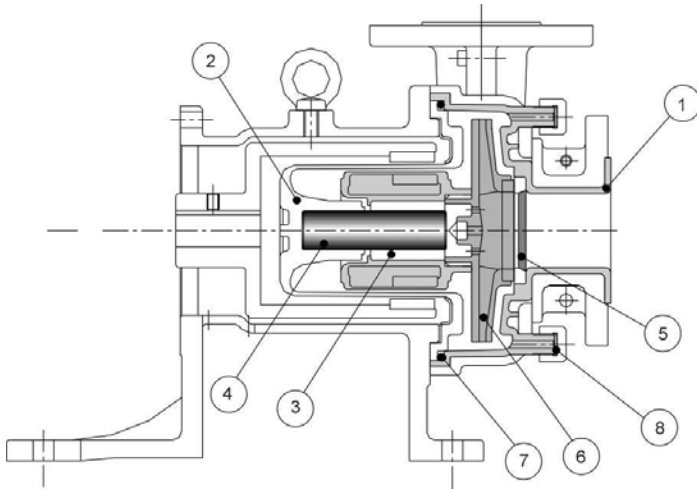

# MDF-L425



- Patented Pinpoint Bearing System allows dry run operation (CF models only)
- Compact design
- Corrosion resistant ETFE internals
- Precision injection molded, individually replaceable, liner components for simple on site maintenance

Part	Material	
	CF	AA
1 Casing Liner	20% carbon reinforced fluoroplastic	
2 Containment shell	ETFE	
3 Bushing	High density carbon	99.8% alumina ceramic
4 Shaft	99.8% alumina ceramic	
5 Thrust collar, inboard		
6 Impeller	20% carbon reinforced fluoroplastic	
	ETFE	
7 O-ring	FKM / EPDM / AFLAS	
8 Gasket		

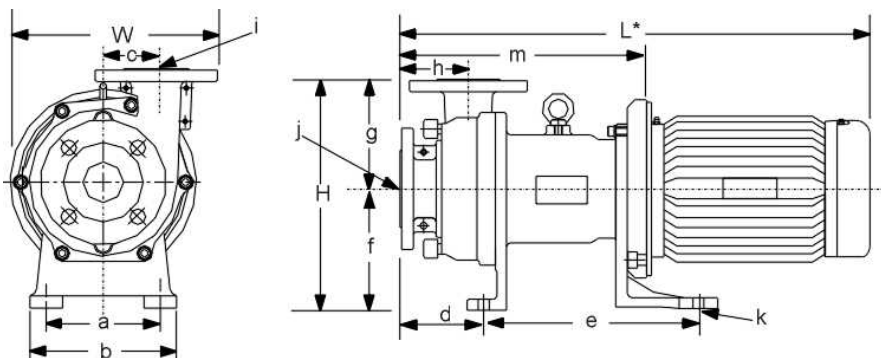
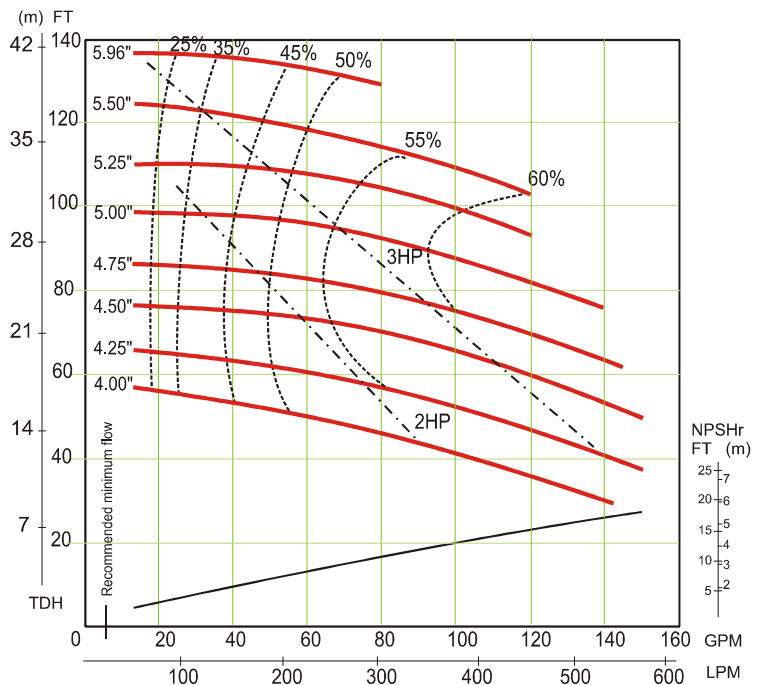

## Dimensions (inches) and Specifications

\* Will vary by motor manufacturer

a	b	c	d	e	f	g	h	i	j	m	k	W	H	L
5.51"	7.09"	2.56"	4.17"	10.83"	6.10"	5.51"	3.43"	1.50"	2.00"	12.36"	0.55"	10.07"	11.61"	26.04"
Connection Sizes			Min Flow/Max Head		Standard Capacity			Max Capacity		Motor/Frame		Pump Weight		
2 x 1.5			13.2 GPM/ 135 ft.		120 GPM/ 95 ft.			150 GPM		5 HP/184TC		71 lbs.		

