

SUBJECT: T8045 Torque Values for Underfill, Overfill, and Air Bleed Valves

Please note that torque values for the Underfill, Overfill, and Air Bleed Valves have been updated due to valves coming loose in the field. These updated torque settings can also be found in Revision D of the T8045 Installation & Service Manual available on the Hydra-Cell website.

<http://www.hydra-cell.com/product/T8045-hydracell-pump.html>

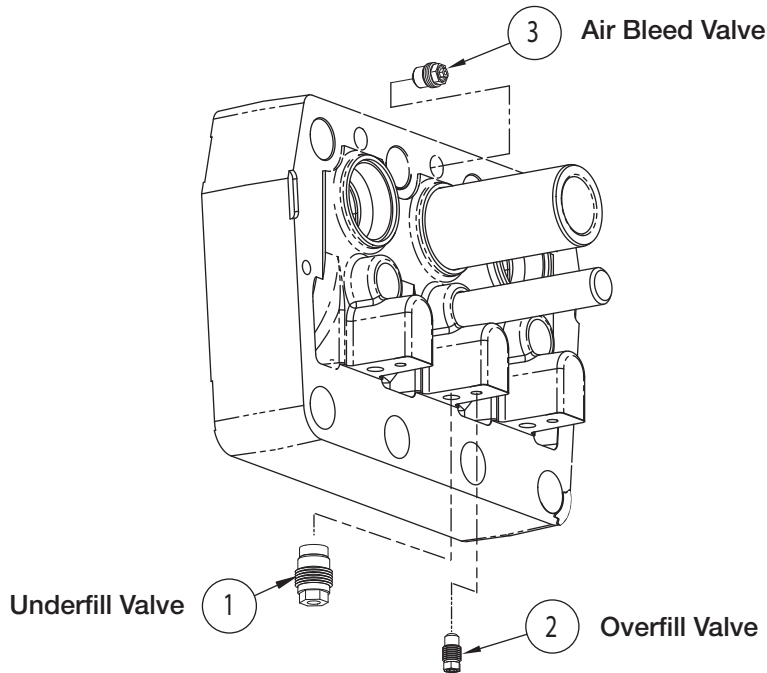

T8045 Torque Specification Table

Reference Number	Part Number	Description	Torque Specification (N-m)
1	177-904	Cartridge, Underfill Valve	144 in-lbs. (16)
2	177-905	Cartridge, Overfill Valve	105 in-lbs. (12)
3	177-906	Cartridge, Air Bleed Valve	205 in-lbs. (23)

Wanner Engineering, Inc.

1204 Chestnut Avenue
 Minneapolis, MN 55403 USA
 Phone: 612-332-5681
 Fax: 612-332-6937
 Toll-Free Fax (USA): 800-332-6812
 Email: sales@wannereng.com
www.Hydra-Cell.com

Wanner International Ltd.

Units 8 & 9, Fleet Business Park
 Sandy Lane, Church Crookham
 Hampshire GU52 8BF, England
 Phone: +(44) 01252 816847
 Fax: +(44) 01252 629242
 Email: sales@wannerint.com
www.WannerInt.com

Wanner Pumps Ltd.

Flat A, 21/F, Chatham Commercial Building
 399 Chatham Road North
 Hunghom, Kowloon, HONG KONG
 Phone: +(852) 3428-6534
 Fax: +(852) 3188-9145
 Email: sales@wannerpumps.com
www.WannerPumps.com