

**Series 2000
Closed Coupled**

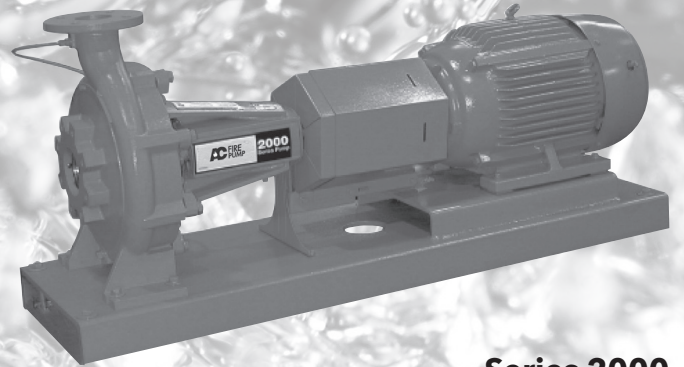

**Series 2000
Frame Mounted**

Series A-C 2000

SINGLE STAGE END SUCTION

Series A-C 2000 End Suction Close Coupled - Model 600

APPLICATIONS

General Industry
Water Supply Condenser
Water Transfer Chilled and Hot Water Circulation

CAPABILITIES

Capacity: to 2000 GPM
Head: to 360 ft. TDH
Temperature: to 250°F

BENEFITS

Rear pull-out, center line discharge and hydraulic balance - three highly desirable design features are combined in the 2000 Series Pump to provide reliable performance at low operating costs.

The highly efficient 2000 Series pump is also unsurpassed in energy conservation, an increasingly important consideration as energy costs continue to climb.

Whenever end suction close coupled pumps are needed, the 2000 Series pump offers more benefits per dollar spent than any other pump at any price.

- **Top center line discharge design** - Simplifies piping layouts, reduces piping strain and is self-venting. Feet are cast integrally with casing for sturdier installation.
- **Rear pull-out** makes servicing simpler, faster. The rotating element is easily removed without disturbing piping.
- **Hydraulic balance of impeller** extends bearing life, assures smoother, quieter operation.
- Available in 28 sizes.
- Lower first cost
- Space-saving
- Available with choice of packing or mechanical seal.
- **Working pressure:** varies by size 175-215 PSI with 125 PSI ANSI flanges.
- Designed for use with NEMA standard close coupled pump motors.

Series A-C 2000 End Suction Frame Mounted - Model 100 and 150

APPLICATIONS

General Industry
Water Supply Condenser
Water Transfer Chilled and Hot Water Circulation

CAPABILITIES

Capacity: to 3100 GPM
Head: to 360 ft. TDH
Temperature: to 250°F

BENEFITS

Rear pull-out, center line discharge and hydraulic balance - three highly desirable design features are combined to provide reliable performance at low operating costs.

The highly efficient 2000 Series pump is also unsurpassed in energy conservation, an increasingly important consideration as energy costs continue to climb.

Whenever end suction frame mounted pumps are needed, the 2000 Series pump offers more benefits per dollar spent than any other pump at any price.

- **Top center line discharge design** - Simplifies piping layouts, reduces piping strain and is self-venting. Feet are cast integrally with casing for sturdier installation.
- **Rear pull-out** makes servicing simpler, faster. The rotating element is easily removed without disturbing piping or driver when spacer type coupling is used.
- **Hydraulic balance of impeller** extends bearing life, assures smoother, quieter operation.
- Available in 30 sizes
- Available with choice of packing or mechanical seal
- **Working pressure:** varies by size 175-215 PSI with 125 PSI ANSI flanges.
- **ANSI/OSHA-COMPLIANT COUPLING GUARD** - The coupler guard complies with ANSI B15.1, Section 8 and OSHA 1910.219. The guard offers increased protection against potential injuries and is standard on all Model 150 pumps. The guards include slotted viewing windows for easy inspection.

60 Cycle Performance Curves - Series A-C 2000 End Suction Close Coupled - Model 600

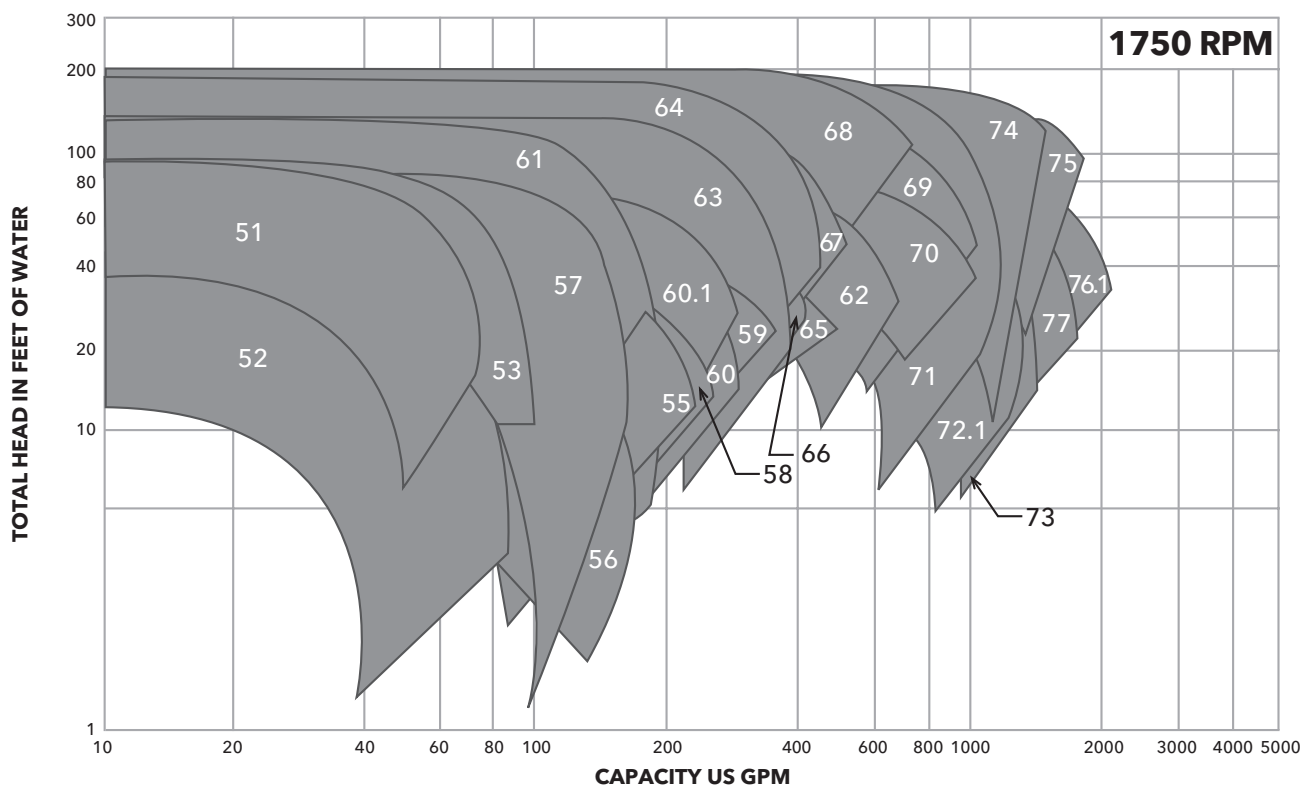
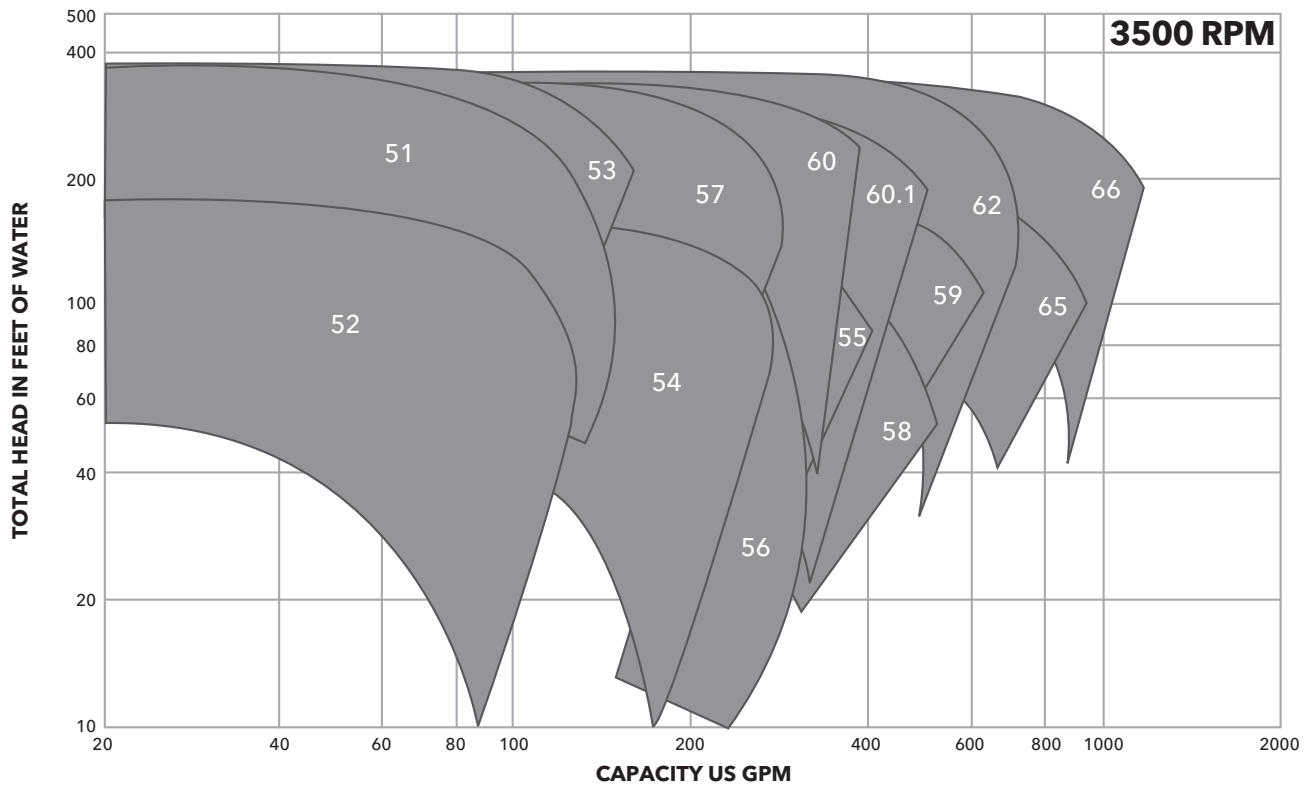

50 Cycle Performance Curves - Series A-C 2000 End Suction Close Coupled - Model 600

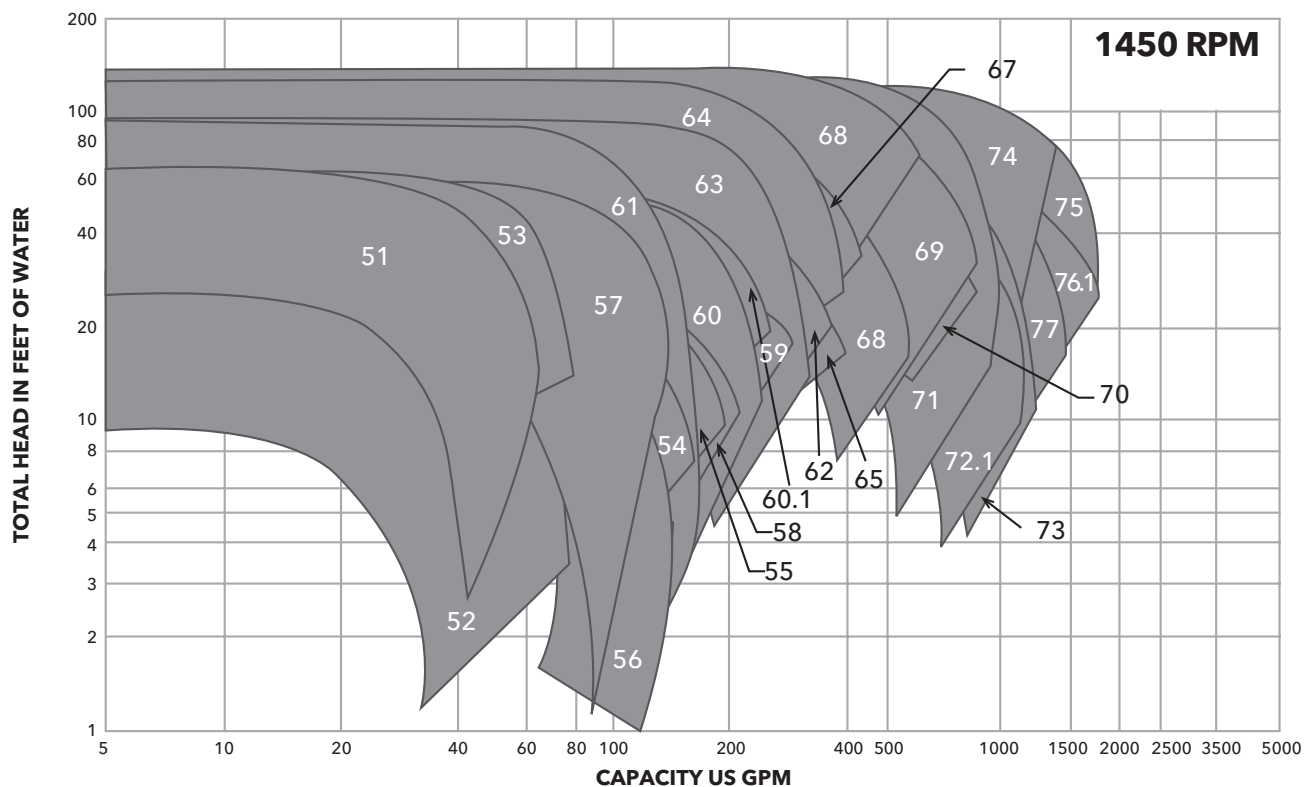
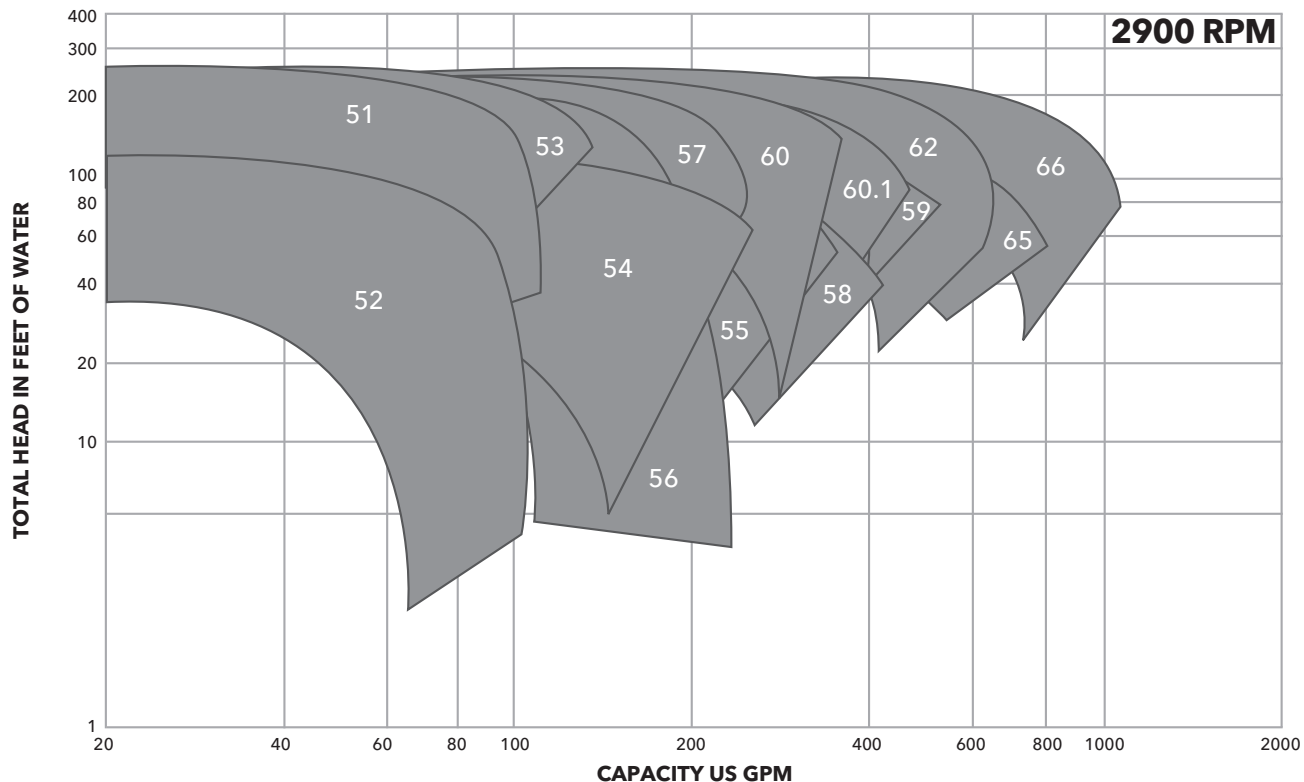

60 Cycle Performance Curves - Series A-C 2000 End Suction Frame Mounted - Model 100 and 150

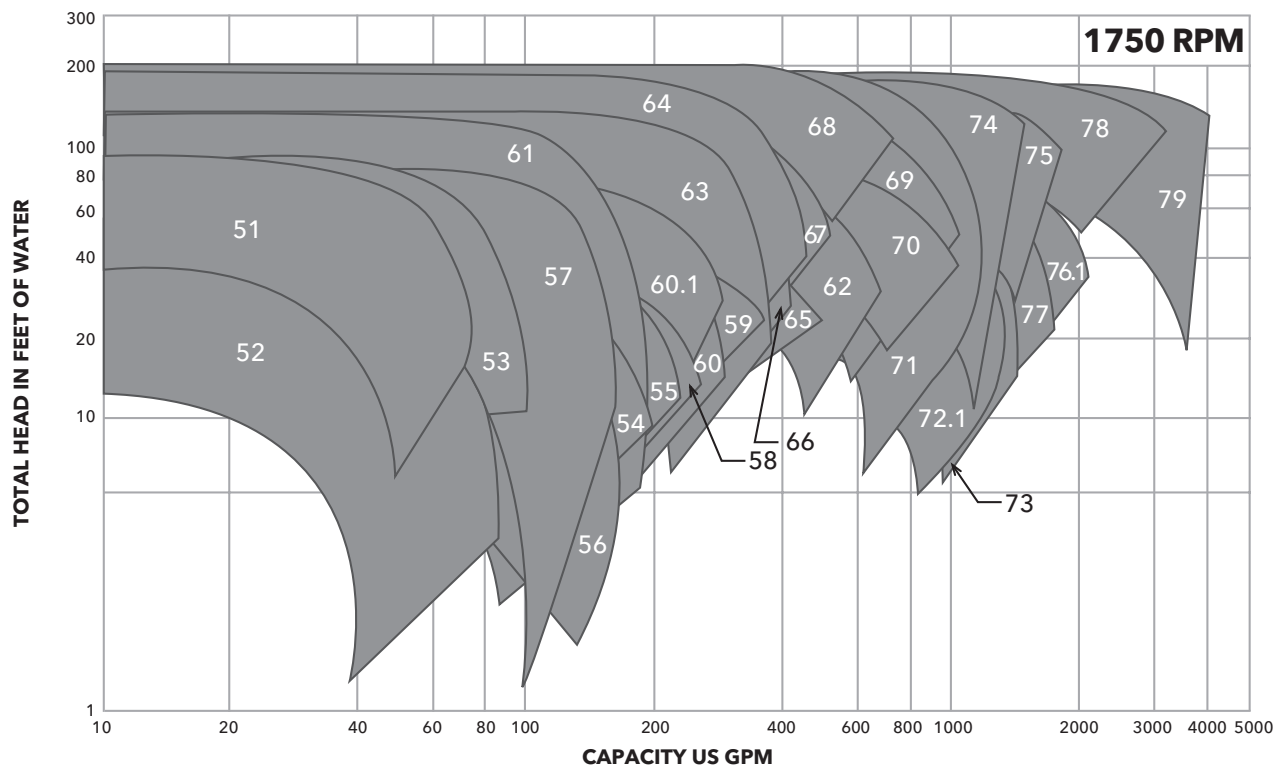
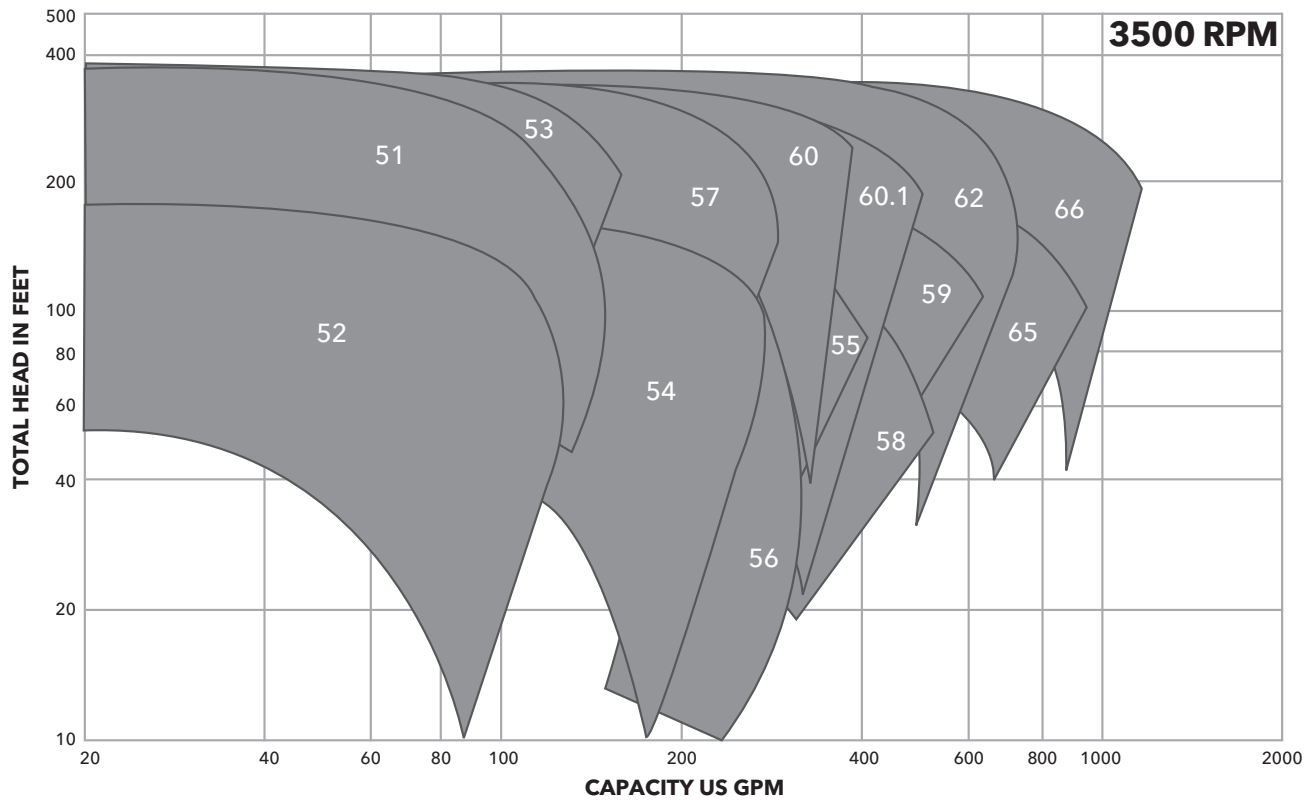

60 Cycle Performance Curves - Series A-C 2000 End Suction Frame Mounted - Model 100 and 150

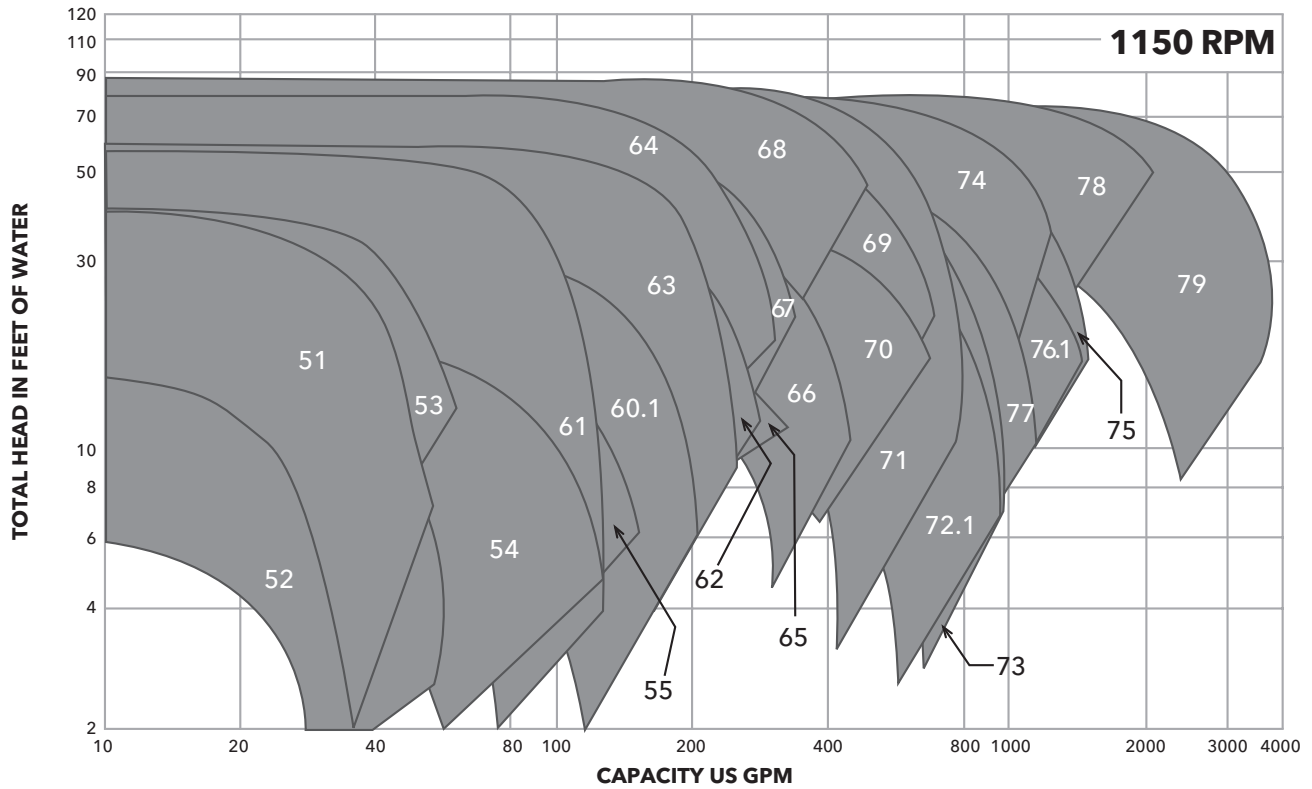

50 Cycle Performance Curves - Series A-C 2000 End Suction Frame Mounted - Model 100 and 150

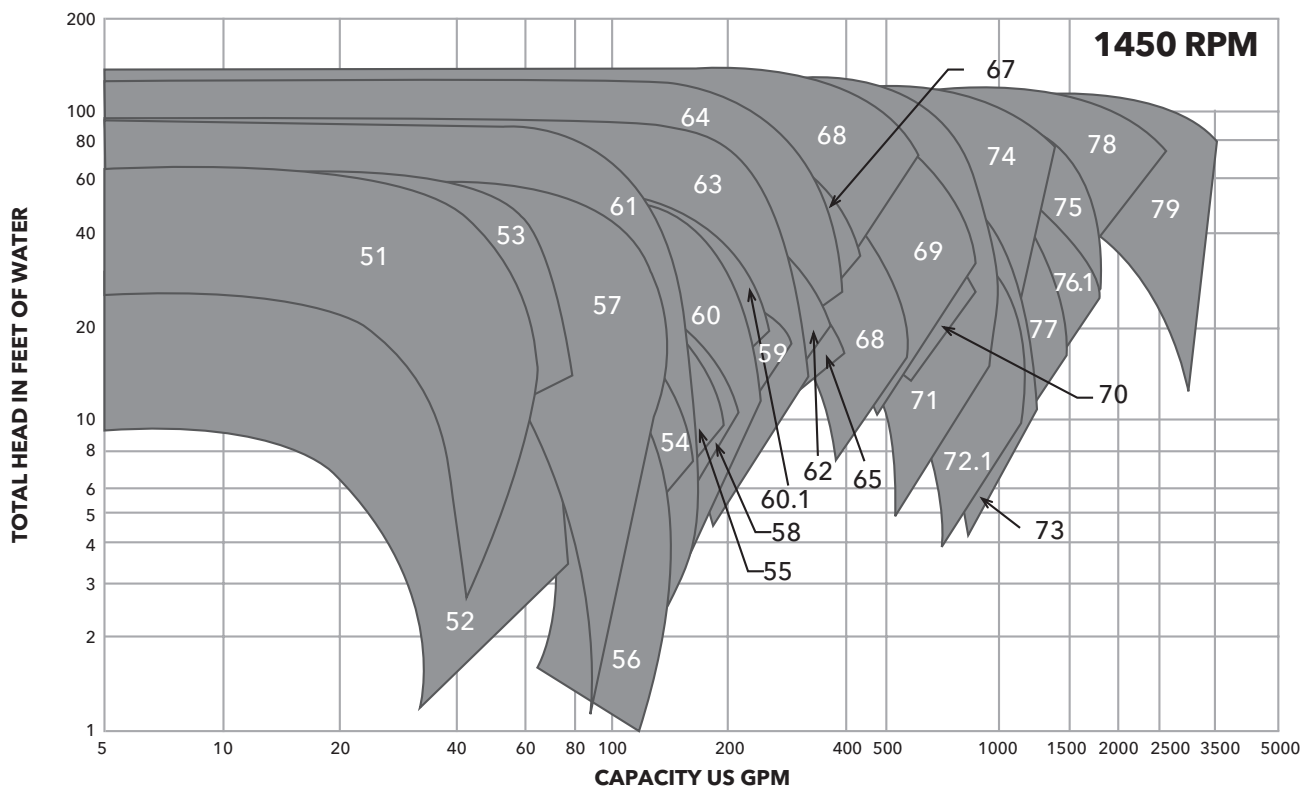
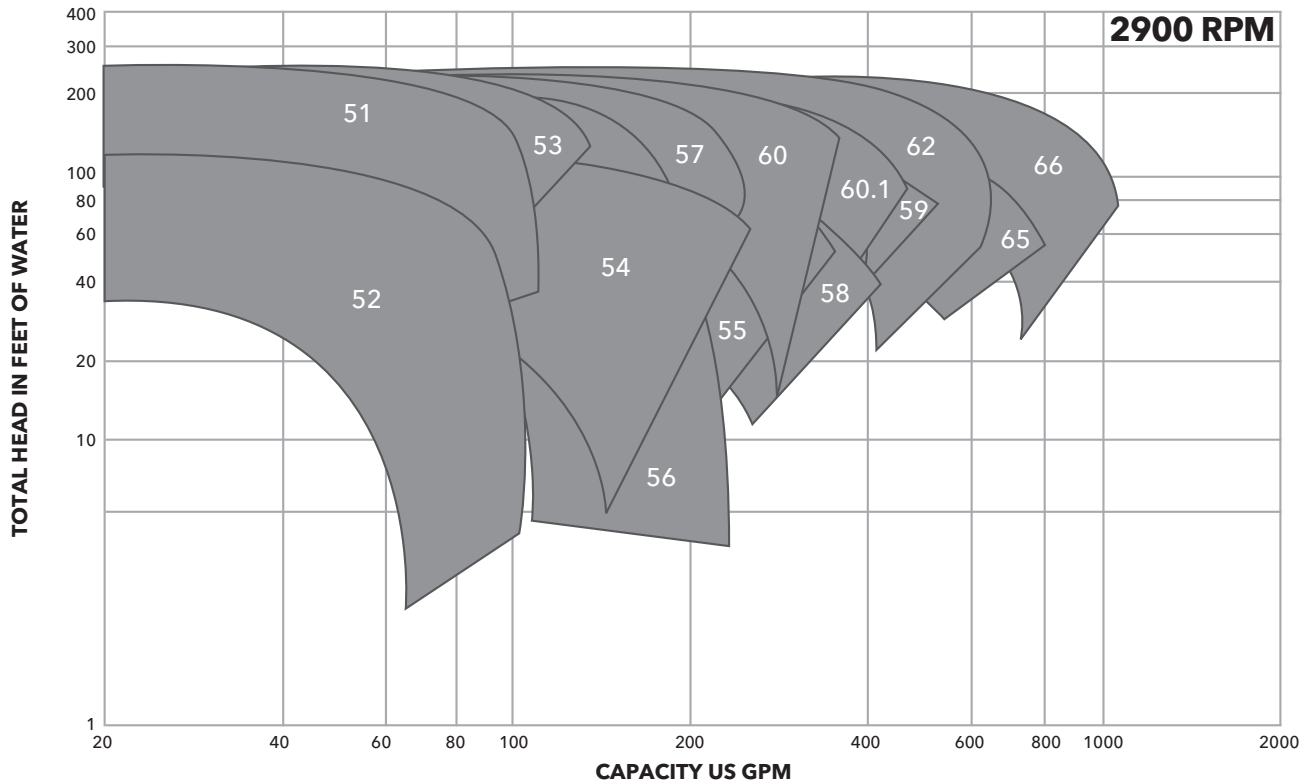

Series A-C 2000

End Suction Close Coupled - Model 600

PUMP SIZES

| Key No. | Pump Size and Type | Key No. | Pump Size and Type |
|---------|--------------------|---------|--------------------|
| 51 | 1.5x1.5x9 | 64 | 3x2.5x13 |
| 52 | 2x1.5x6.5 | 65 | 4x3x6.5 |
| 53 | 2x1.5x9 | 66 | 4x3x9 |
| 54 | 2.5x2x6.5S | 67 | 4x3x11 |
| 55 | 2.5x2x6.5L | 68 | 4x3x13 |
| 56 | 2.5x2x9S | 69 | 4x4x11 |
| 57 | 2.5x2x9L | 70 | 6x4x9 |
| 58 | 3x2x6.5S | 71 | 6x4x13 |
| 59 | 3x2x6.5L | 72.1 | 6x6x9.5 |
| 60 | 3x2x9 | 73 | 6x6x11 |
| 60.1 | 3x2x10 | 74 | 6x6x13S |
| 61 | 3x2x11 | 75 | 6x6x13L |
| 62 | 3x2.5x9 | 76.1 | 8x6x9.5 |
| 63 | 3x2.5x11 | 77 | 8x6x11 |

MATERIAL

| Part | All Cast Iron | Bronze Fitted |
|----------------------------------|------------------------------------|---------------|
| Casing | Cast Iron | |
| Wearing Rings (optional) | Cast Iron | Bronze Alloy |
| Stuffing Box | Cast Iron | |
| Impeller | Cast Iron | Bronze Alloy |
| Shaft Sleeve | 400 Stainless Steel | Bronze Alloy |
| Impeller Nut and Washer | Plated Steel | |
| Gland | 300 Stainless Steel | Zinc Alloy |
| Mechanical Seal (when furnished) | Ni-resist, Carbon, Stainless Steel | |
| Packing (when furnished) | Graphited Acrylic Yarn | |
| Seal Cage (when furnished) | Teflon | |
| Shaft | Steel | |
| Adaptor (close-coupled) | Cast Iron | |

CLOSE-COUPLED SERIES A-C 2000 PUMP WITH MECHANICAL SEAL

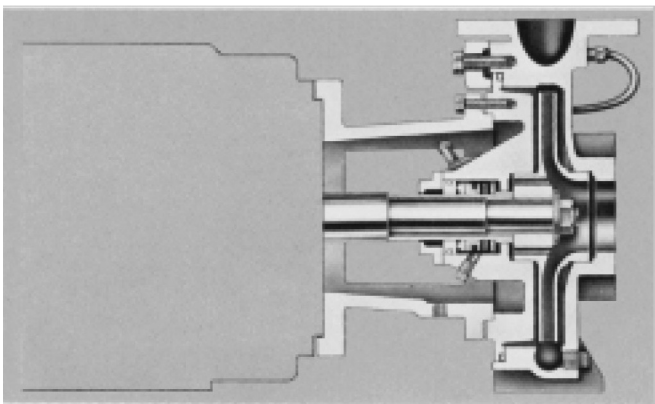

CLOSE-COUPLED SERIES A-C 2000 PUMP WITH PACKING

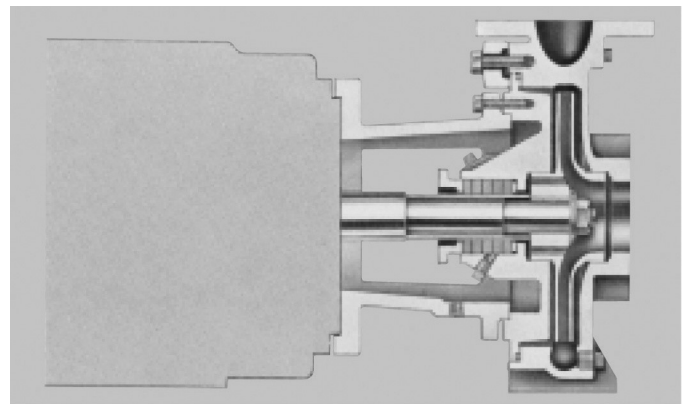

Series A-C 2000

End Suction Frame Mounted - Model 100 and 150

PUMP SIZES

| Key No. | Pump Size and Type | Key No. | Pump Size and Type |
|---------|--------------------|---------|--------------------|
| 51 | 1.5x1.5x9 | 65 | 4x3x6.5 |
| 52 | 2x1.5x6.5 | 66 | 4x3x9 |
| 53 | 2x1.5x9 | 67 | 4x3x11 |
| 54 | 2.5x2x6.5S | 68 | 4x3x13 |
| 55 | 2.5x2x6.5L | 69 | 4x4x11 |
| 56 | 2.5x2x9S | 70 | 6x4x9 |
| 57 | 2.5x2x9L | 71 | 6x4x13 |
| 58 | 3x2x6.5S | 72.1 | 6x6x9.5 |
| 59 | 3x2x6.5L | 73 | 6x6x11 |
| 60 | 3x2x9 | 74 | 6x6x13S |
| 60.1 | 3x2x10 | 75 | 6x6x13L |
| 61 | 3x2x11 | 76.1 | 8x6x9.5 |
| 62 | 3x2.5x9 | 77 | 8x6x11 |
| 63 | 3x2.5x11 | 78 | 8x6x13 |
| 64 | 3x2.5x13 | 79 | 10x8x13 |

MATERIAL

| Part | All Cast Iron | Bronze Fitted |
|----------------------------------|------------------------------------|---------------|
| Casing | Cast Iron | |
| Wearing Rings (optional) | Cast Iron | Bronze Alloy |
| Stuffing Box | Cast Iron | |
| Impeller | Cast Iron | Bronze Alloy |
| Shaft Sleeve | 400 Stainless Steel | Bronze Alloy |
| Impeller Nut and Washer | Plated Steel | |
| Gland | 300 Stainless Steel | Zinc Alloy |
| Mechanical Seal (when furnished) | Ni-resist, Carbon, Stainless Steel | |
| Packing (when furnished) | Graphited Acrylic Yarn | |
| Seal Cage (when furnished) | Teflon | |
| Shaft | Steel | |
| Adaptor (close-coupled) | Cast Iron | |

FRAME MOUNTED SERIES A-C 2000 PUMP WITH MECHANICAL SEAL

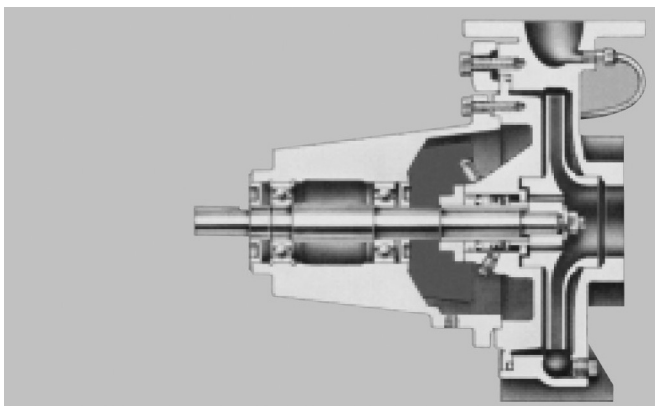

Options: casing wearing rings, 416 stainless steel shaft, spacer type coupling.

FRAME MOUNTED SERIES A-C 2000 PUMP WITH PACKING

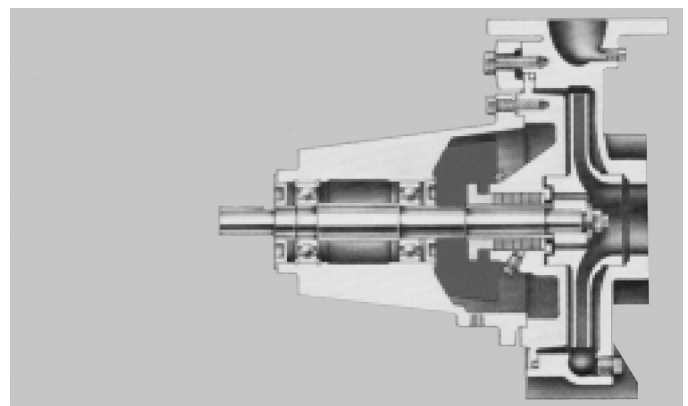

Options: casing wearing rings, seal cage, liquid seal tubing, 416 stainless steel shaft, stainless steel shaft sleeve, hardened stainless steel shaft sleeve, spacer type coupling, channel drip rim baseplate.

NOTES

NOTES

Xylem |'zīləm|

- 1) The tissue in plants that brings water upward from the roots;
- 2) a leading global water technology company.

We're 12,500 people unified in a common purpose: creating innovative solutions to meet our world's water needs. Developing new technologies that will improve the way water is used, conserved, and re-used in the future is central to our work. We move, treat, analyze, and return water to the environment, and we help people use water efficiently, in their homes, buildings, factories and farms. In more than 150 countries, we have strong, long-standing relationships with customers who know us for our powerful combination of leading product brands and applications expertise, backed by a legacy of innovation.

For more information on how Xylem can help you, go to www.xyleminc.com



Xylem Inc.
2881 East Bayard Street Ext., Suite A
Seneca Falls, NY 13148
Phone: (800) 453-6777
Fax: (888) 322-5877
www.gouldswatertechnology.com