

Centrifugals - Close Coupled

FLANGED CASING ASSEMBLY

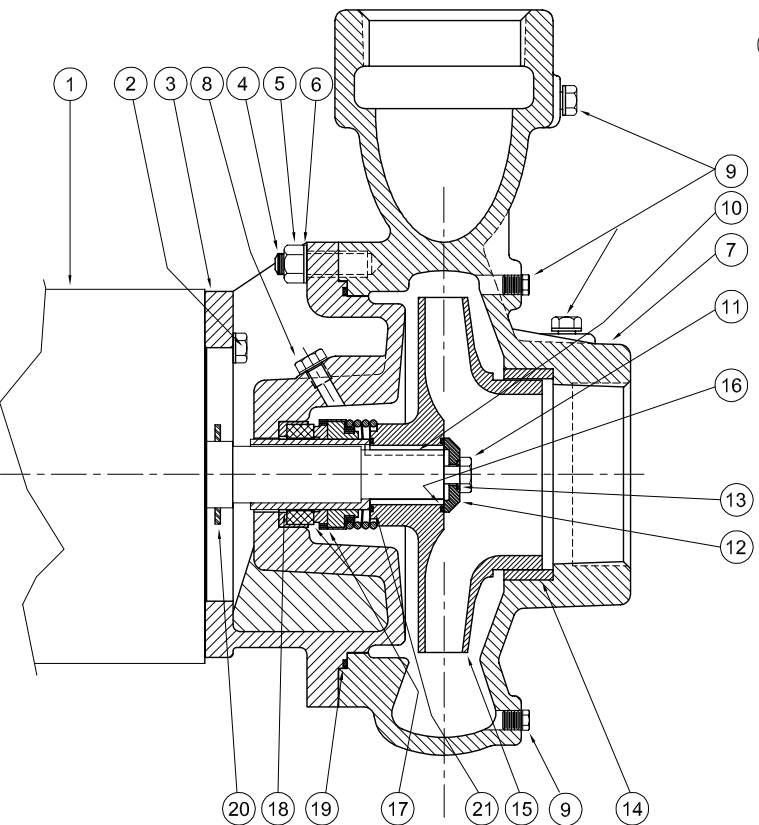
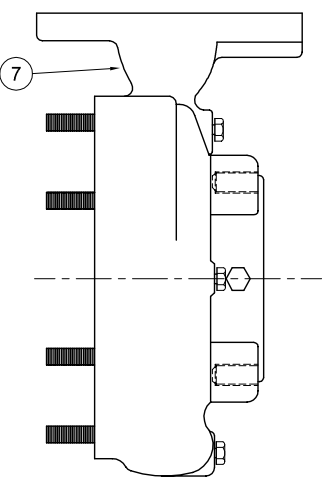

| 1 - MOTORS | | | |
|------------------------------------|-------------|----|------------|
| RPM & PHASE | PART NUMBER | HP | FRAME SIZE |
| OPEN DRIP PROOF | | | |
| 1750 RPM Single Phase (ODP) | 21393 | 1 | 143JM |
| | 21394 | 1½ | 145JM |
| | 21395 | 2 | 182JM |
| 1750 RPM Three Phase (ODP) | 21419 | 1 | 143JM |
| | 21420 | 1½ | 145JM |
| | 21421 | 2 | 145JM |
| 3500 RPM Three Phase (ODP) | 09907 | 7½ | 184JM |
| | 09999 | 10 | 213JM |
| | 20002 | 15 | 215JM |
| | 21169 | 20 | 254JM |
| TOTALLY ENCLOSED | | | |
| 1750 RPM Single Phase (TEFC) | 21399 | 1 | 143JM |
| | 21400 | 1½ | 145JM |
| | 21401 | 2 | 182JM |
| | 21402 | 3 | 184JM |
| 1750 RPM Three Phase (TEFC) | 21426 | 1 | 143JM |
| | 21427 | 1½ | 145JM |
| | 21428 | 2 | 145JM |
| | 21429 | 3 | 182JM |
| 3500 RPM Three Phase (TEFC) | 09951 | 7½ | 213JM |
| | 20000 | 10 | 215JM |
| | 20003 | 15 | 254JM |
| | 21195 | 20 | 256JM |
| EXPLOSION PROOF | | | |
| 1750 RPM Three Phase (XP) | 21433 | 1 | 143JM |
| | 21434 | 1½ | 145JM |
| | 21435 | 2 | 145JM |
| | 21436 | 3 | 182JM |
| 3500 RPM Three Phase (XP) | 09955 | 7½ | 213JM |
| | 20001 | 10 | 215JM |
| | 20004 | 15 | 254JM |
| | 21196 | 20 | 256JM |

| SYMBOL NUMBER | PART NUMBER | QTY | DESCRIPTION | |
|------------------------------------|------------------------------------|-----|--|--|
| PUMPS with 143-215JM Motors | | | | |
| +16 | 09933 | 1 | Flat Gasket + | |
| | 22083 | 1 | O-Ring Gasket - Buna N (Std) | |
| | 22084 | 1 | O-Ring Gasket - Viton | |
| | 22094 | 1 | O-Ring Gasket - EPT** | |
| | 22085 | 1 | O-Ring Gasket - Teflon | |
| PUMPS with 254-256JM Motors | | | | |
| +16 | 21090 | 1 | Flat Gasket + | |
| | 22140 | 1 | O-Ring Gasket - Buna N (Std) | |
| | 22141 | 1 | O-Ring Gasket - Viton | |
| | 22143 | 1 | O-Ring Gasket - EPT** | |
| | 22142 | 1 | O-Ring Gasket - Teflon | |
| PUMPS with 143-215JM Motors | | | | |
| 17 | 09917 | 1 | Mechanical Seal - Buna-N (Std) | |
| | 09926 | 1 | Mechanical Seal - Viton | |
| | 21271 | 1 | Mechanical Seal - EPT** | |
| | PUMPS with 254-256JM Motors | | | |
| | 21136 | 1 | Mechanical Seal - Buna-N (Std) | |
| 18 | 21189 | 1 | Mechanical Seal - Viton | |
| | 21721 | 1 | Mechanical Seal - EPT** | |
| | 22063-C | 1 | Shaft Sleeve - Bronze - 143-215JM Motors | |
| +19 | 22066 | 1 | Shaft Sleeve - Bronze - 254-256JM Motors | |
| | 09916 | 1 | Flat Gasket + | |
| +19 | 22099 | 1 | O-Ring Gasket - Buna N (Std) | |
| | 23000 | 1 | O-Ring Gasket - Viton | |
| | 23001 | 1 | O-Ring Gasket - EPT** | |
| | 23002 | 1 | O-Ring Gasket - Teflon | |
| 20 | 09918 | 1 | Slinger Washer - 143-215JM Motors | |
| | 21093 | 1 | Slinger Washer - 254-256JM Motors | |
| PUMPS with 143-215JM Motors | | | | |
| +21 | 09911 | 1 | Flat Gasket + | |
| | 22083 | 1 | O-Ring Gasket - Buna N (Std) | |
| | 22084 | 1 | O-Ring Gasket - Viton | |
| | 22094 | 1 | O-Ring Gasket - EPT** | |
| | 22085 | 1 | O-Ring Gasket - Teflon | |
| PUMPS with 254-256JM Motors | | | | |
| +21 | 21092 | 1 | Flat Gasket + | |
| | 22089 | 1 | O-Ring Gasket - Buna N (Std) | |
| | 22090 | 1 | O-Ring Gasket - Viton | |
| | 22096 | 1 | O-Ring Gasket - EPT** | |
| | 22091 | 1 | O-Ring Gasket - Teflon | |

"CONTINUED ON NEXT PAGE"

| SYMBOL NUMBER | PART NUMBER | QTY | DESCRIPTION |
|------------------------------------|--------------|-----|---------------------------------------|
| 2 | 01928 | 4 | Cap Screw - for 09912 Adapter |
| | 1-68-6 | 4 | Cap Screw - for 09920 & 21345 Adapter |
| 3 | 09912 | 1 | Adapter - 143-184JM Motors |
| | 09920 | 1 | Adapter - 213-215JM Motors |
| | 21345 | 1 | Adapter - 254-256 JM Motors |
| 4 | 03075 | 8 | Stud |
| 5 | 15-23-6 | 8 | Nut |
| 6 | 01609-A | 8 | Washer |
| *7 | 22152 | 1 | Casing Assy |
| | 22270 | 1 | Casing Assy (Flanged) |
| 8 | 04236 | 1 | Pipe Plug - 1/4" Bronze |
| 9 | 01691-A | 6 | Pipe Plug, 1/8" - Bronze |
| 10 | 23014 | 1 | Key - 143-215JM Mptors |
| | 22107 | 1 | Key - 254-256JM Motors |
| 11 | 1-529-1 | 1 | Cap Screw, SS - 143-215JM Motors |
| | 01638-A | 1 | Cap Screw, SS - 254-256JM Motors |
| 12 | 22105-C | 1 | Washer, Bronze - 143-215JM Motors |
| | 22106 | 1 | Washer, Bronze - 254-256JM Motors |
| PUMPS with 143-215JM Motors | | | |
| 13 | 22080 | 1 | O-Ring Gasket - Buna N (Std) |
| | 2-31005-012 | 1 | O-Ring Gasket - Viton |
| | 22093 | 1 | O-Ring Gasket - EPT** |
| | 22082 | 1 | O-Ring Gasket - Teflon |
| PUMPS with 254-256JM Motors | | | |
| 13 | 22086 | 1 | O-Ring Gasket - Buna N (Std) |
| | 22087 | 1 | O-Ring Gasket - Viton |
| | 22095 | 1 | O-Ring Gasket - EPT** |
| | 22088 | 1 | O-Ring Gasket - Teflon |
| 14 | 20680 | 1 | Wear Ring - Bronze |
| 1750 RPM | | | |
| 15 | 20678-5.25 | 1 | Impeller - 104G6-2-1/2 & 3104G6-2-1/2 |
| | 20678-5.75 | 1 | Impeller - 154G6-2-1/2 & 3154G6-2-1/2 |
| | 20678-6.31 | 1 | Impeller - 204G6-2-1/2 & 3204G6-2-1/2 |
| 3450 RPM | | | |
| 15 | 20678-5.13 | 1 | Impeller - 375G6-2-1/2 |
| | 20678-5.50 | 1 | Impeller - 3100G6-2-1/2 |
| | 20678-6.31 | 1 | Impeller - 3150G6-2-1/2 |
| | 20678-1-6.31 | 1 | Impeller - 3200G6-2-1/2 |

(*) Casing Assy. Includes Symbols 4, 9 & 14.

(**) For hot water or Caustic service.

(+) Series G6-2-1/2 pumps have been manufactured with either a flat or O-ring type gasket. Determine which type is required before ordering. When in doubt, order flat gasket.

Centrifugals - Close Coupled

| SYMBOL NUMBER | PART NUMBER | QTY | DESCRIPTION |
|--|-------------|-----|---|
| DIFFERING PARTS FOR ALL BRONZE CONSTRUCTION | | | |
| 3 | 09912-B | 1 | Adapter - 143-184JM Motors |
| | 09920-B | 1 | Adapter - 213-215JM Motors |
| | 21345-A | 1 | Adapter - 254-256 JM Motors |
| *7 | 22152-A | 1 | Casing Assy |
| | 22270-A | 1 | Casing Assy (Flanged) |
| 11 | 03289 | 1 | Cap Screw, Bronze - 143-215JM Motors |
| | 01638-B | 1 | Cap Screw, Bronze - 254-256JM Motors |
| DIFFERING PARTS FOR ALL IRON CONSTRUCTION | | | |
| 2 | 03289 | 4 | Cap Screw - for 09912-B Adapter |
| | 01638-B | 4 | Cap Screw - for 09920-B & 21345-A Adapter |
| 5 | 05536 | 8 | Nut |
| 6 | 01609-B | 8 | Washer |
| *7 | 22152-B | 1 | Casing Assy |
| | 22270-B | 1 | Casing Assy (Flanged) |
| 8 | 04236-A | 1 | Pipe Plug 1/4" SS |
| 9 | 00158 | 6 | Pipe Plug 1/8" Steel |
| | 22105-A | 1 | Washer - Steel - 143-215JM Motors |
| 12 | 22106-A | 1 | Washer - Steel - 254-256JM Motors |
| | | | |
| 14 | 20680-A | 1 | Wear Ring - G6-1-1/2 |
| 15 | 20678-A | 1 | Impeller - 143-215JM Motors |
| | 20678-A-1 | 1 | Impeller - 254-256JM Motors |
| | | | Impeller size suffixes same as standard bronze impellers. |
| 18 | 22063-A | 1 | Shaft Sleeve - SS - 143-215JM Motors |
| | 22066-A | 1 | Shaft Sleeve - SS - 254-256JM Motors |

(*) Casing Assy. Includes Symbols 4, 9 & 14.

(**) For hot water or Caustic service.

(+) Series G6-2-1/2 pumps have been manufactured with either a flat or O-ring type gasket. Determine which type is required before ordering. When in doubt, order flat gasket.

SECTION
PAGE
DATE

CCCP
26
2/05

CRANE[®]

A Crane Co. Company

PUMPS & SYSTEMS

USA: (937) 778-8947 • Canada: (905) 457-6223 • International: (937) 615-3598