

Fluid-o-Tech Rotary Vane Pumps Optional Mountings

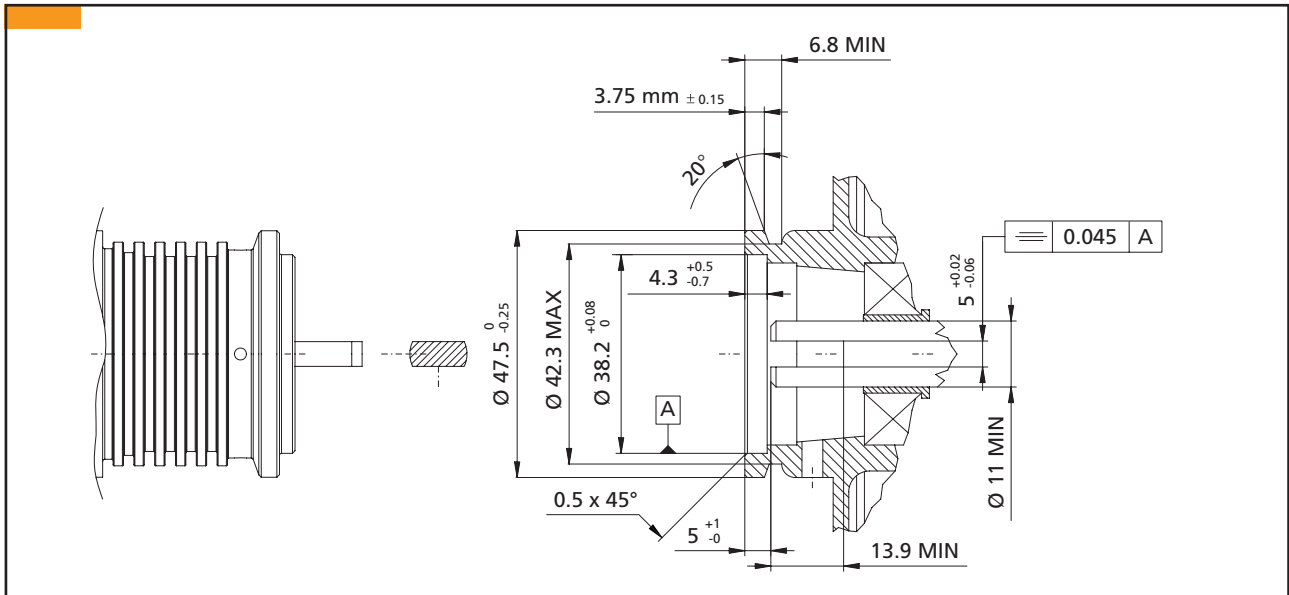

Notes: The drawing illustrates the minimum dimensional requirement of the motor in order to grant the proper alignment between pump and motor.

Tool AT-190_1 is available upon request to verify the compliance of the motor to the above requirements.

Misalignment between motor and pump shaft might cause excessive noise at first and damage to pump and/or motor afterwards with possible leakages of liquid and subsequent blockage of the unit.

PO/PA/MO/MA/CO/CA Series

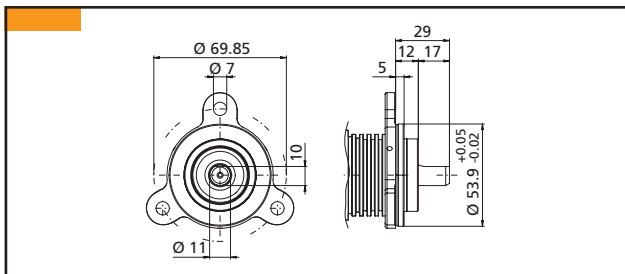

Flange Mounting

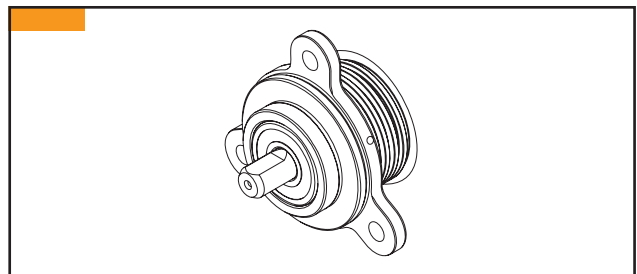

PO/PA/MO/MA/CO/CA Series

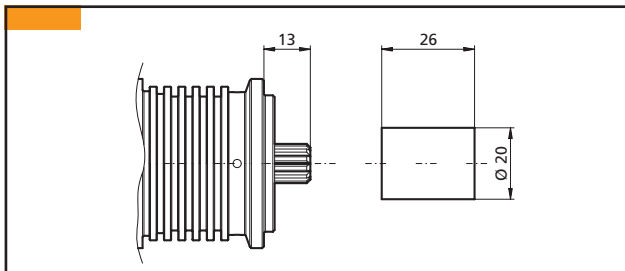

Splined Shaft with Coupling

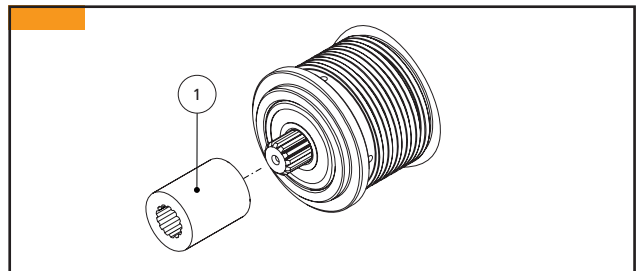

POS.	DESCRIPTION	MATERIAL	CODE	QUANTITY
1	SPLINED COUPLING	PLASTIC	22378	1

Fluid-o-Tech Rotary Vane Pumps Optional Mountings

PO/PA/MO/MA/CO/CA Series

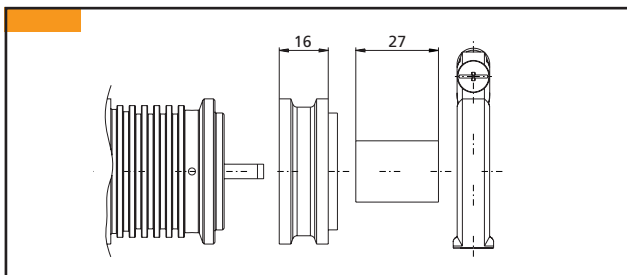

Dumper Coupling Kit 48YZ

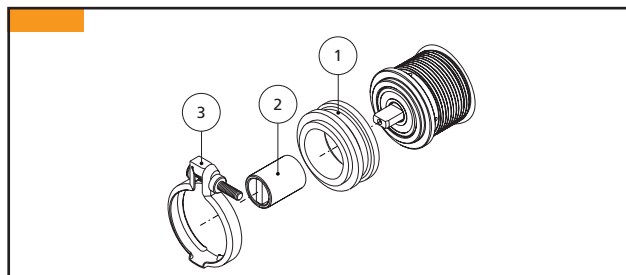

POS.	DESCRIPTION	MATERIAL	CODE	QUANTITY
1	ADAPTER 48YZ	PLASTIC	22515	1
2	CROSS COUPLING MALE/FEMALE	PLASTIC	22477	1
3	CLAMP		22056	1

PO/PA/MO/MA/CO/CA Series

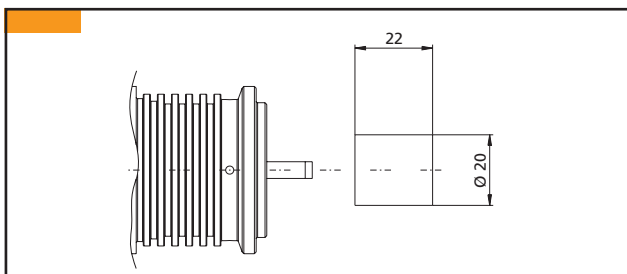

Dumper Coupling for RPM Motors

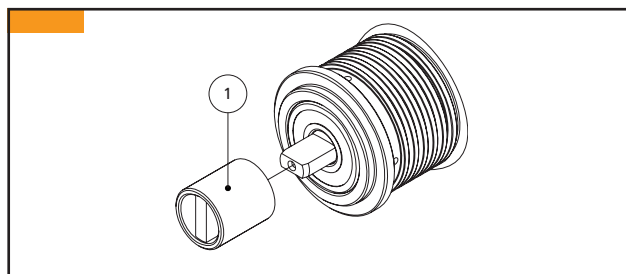

POS.	DESCRIPTION	MATERIAL	CODE	QUANTITY
1	COUPLING MALE/FEMALE	PLASTIC	22604	1

PO/PA/MO/MA/CO/CA Series

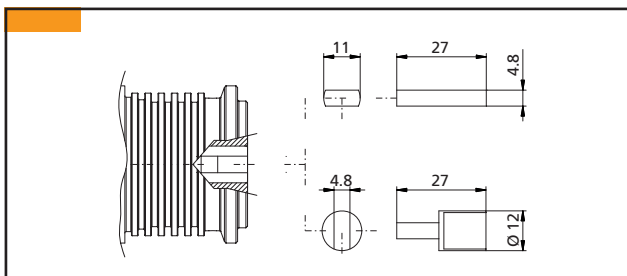

Female Shaft with Coupling

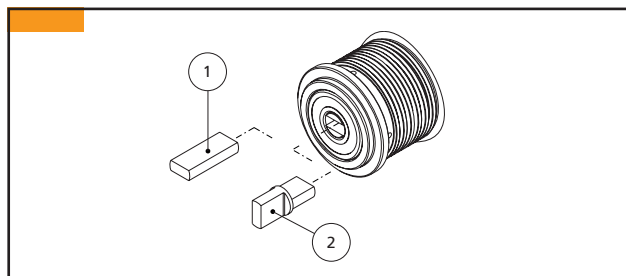

POS.	DESCRIPTION	MATERIAL	CODE	QUANTITY
1	FLAT COUPLING MALE/MALE	PLASTIC	22412	1
2	CROSS COUPLING MALE/FEMALE	BRASS	22508	1

Note: All measures in mm.

Fluid-o-Tech reserves the right to alter the specifications indicated in this catalogue at any time and without prior notice.

PO OM – 12/08 Ed.

Fluid-o-Tech srl
Via Leonardo da Vinci, 40
20094 Corsico, Milano, Italy
Tel. +39 02 8917071
Fax +39 02 89170799

Fluid-o-Tech Int'l Inc.
161 Atwater St.,
Plantsville CT (USA) 06479
Tel. +1 (860) 276-9270
Fax +1 (860) 620-0193

Fluid-o-Tech Int'l Inc. Japan
203, 2-17-19, Ebara, Shinagawa
Tokyo 142-0063, Japan
Tel. +81 (0) (3) 3783-9660
Fax +81 (0) (3) 3783-9661

Fluid-o-Tech Asia (Beijing) Co., Ltd
Jingwei Industrial Zone,
Beifang Huairou, Beijing, 101400, PRC
Tel. +86 (0) (10) 61684650
Fax +86 (0) (10) 61684651